

-18°C ÷ 80°C



Max working pressure:
12 Bar



Compressed air and fluids
suitable with construction
materials



Taper gas BSPT ISO 7
from R1/8" to R1/2"



Body: Nickel-plated brass
(9611TR18, 9611TR14, 9611TR38)
Steel (9611TR12)
Handle: Nickel-plated brass
(9611TR18, 9611TR14, 9611TR38)
Steel (9611TR12)



Products in compliance with
EC Regulation 1907/2006



Products in compliance with
the directive EU 2015/863

CONSTRUCTION DETAILS

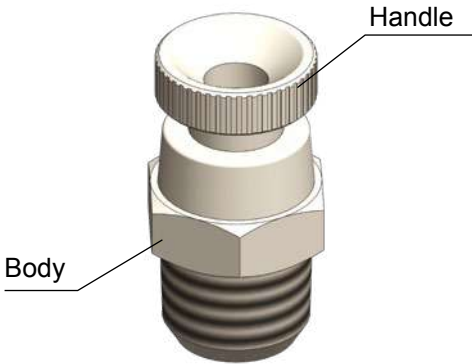

9611

Condensate drain valve BSPT thread

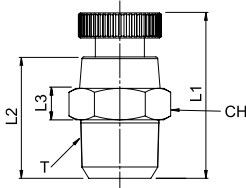

CODE	T	L1	L2	L3	CH
9611TR18	R 1/8"	29	20,5	6,5	12
9611TR14	R 1/4"	24	16	5	14
9611TR38	R 3/8"	22,5	15	5	17
9611TR12	R 1/2"	27	19	6	22

