

Carbon steel

1/1

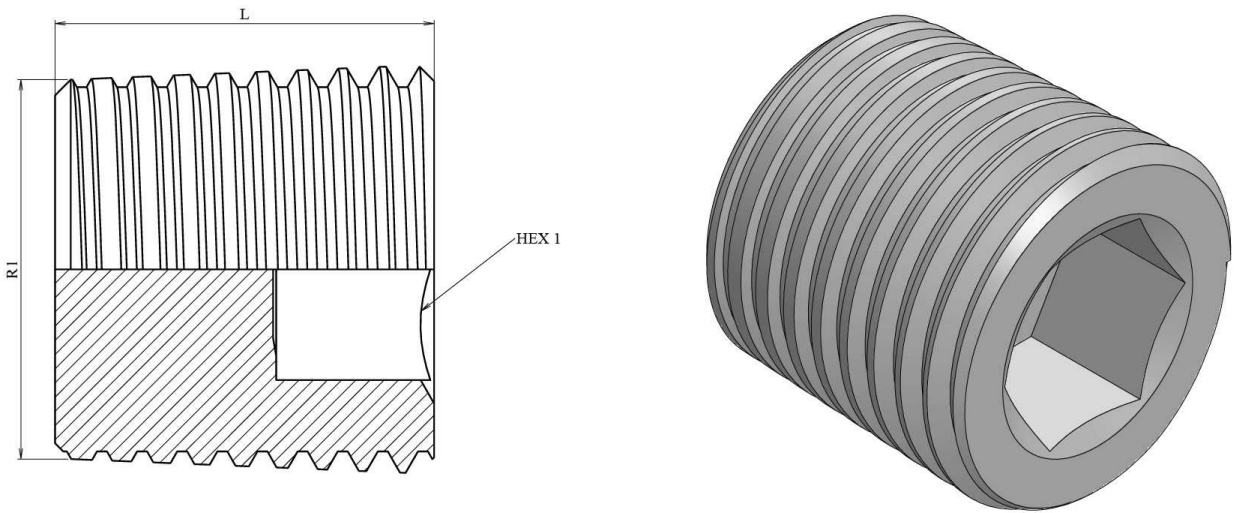

Part nº	R1	L	HEX 1
<b>N107104</b>	1/4" NPT	10,5	6,45
<b>N107106</b>	3/8" NPT	12	8
<b>N107108</b>	1/2" NPT	16	9,5
<b>N107112</b>	3/4" NPT	16	12
<b>N107116</b>	1" NPT	20	17

The material can be provided with imperial hexagons