

ACT Mounting Hardware Multi-Level Installation (with Weld Plate)

Required components for each level:

- 2 ACT Stacking Bolt AF...W55
- 1 ACT Safety Locking Plate SIG...ACT-W55
- 1 ACT Clamp Body (2 Clamp Halves)

The upper layer is secured by a cover plate and hexagon head bolts. The lower layer has to be mounted to a weld plate (with a recommended maximum of two levels in total).

Material Code
W55

ACT Mounting Hardware Material Properties and Handling Instructions

ACT Mounting Hardware is made of Stainless Steel V4A (Material Code: W55) with enhanced corrosion resistance by practically excluding metallic and non-metallic impurities during production, processing and handling.

ACT Mounting Hardware is always delivered in hermetically-sealed quality storage bags with 25 pieces each to avoid contamination during transport.

Always make sure that ACT Mounting Hardware is stored separately from carbon steel and any other metals, and that appropriate tools are used to assemble the clamps.

Details: www.stauff.com/act/assembly

ACT Stacking Bolt Type AF ... W55

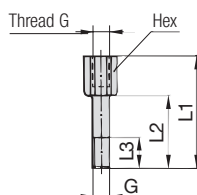

| Group | STAUFF | DIN | Dimensions (mm / in) | Ordering Code | Packaging Unit |
|-------|--------|-----|----------------------------------|-----------------------|-------------------|
| | | | G L1 L2 L3 min. Hex | | (in pieces / bag) |
| 1A | 1 | M6 | 34 20 12 11 1.34 .79 .47 .43 | AF-1/1A/1D-M-W55 | 25 |
| 2 | 2 | M6 | 40 26 12 11 1.57 1.24 .47 .43 | AF-2-M-W55 | 25 |
| 3 | 3 | M6 | 44 30 12 11 1.73 1.18 .47 .43 | AF-3/AF-HKSK-1A-M-W55 | 25 |
| 4 | 4 | M6 | 49 35 12 11 1.93 1.38 .47 .43 | AF-4/AF-HKSK-1D-M-W55 | 25 |
| 5 | 5 | M6 | 64 50 12 11 2.52 1.97 .47 .43 | AF-5-M-W55 | 25 |

ACT Safety Locking Plate Type SIG ... ACT-W55

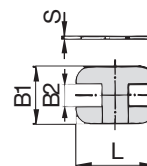

| Group | STAUFF | DIN | Dimensions (mm / in) | Ordering Code | Packaging Unit |
|-------|--------|-----|-----------------------------------|----------------|-------------------|
| | | | L B1 B2 S | | (in pieces / bag) |
| 1A | 1 | | 33 28 11,2 2 1.30 1.10 .44 .08 | SIG-1A-ACT-W55 | 25 |
| 2 | 2 | | 39 28 11,2 2 1.54 1.10 .44 .08 | SIG-2-ACT-W55 | 25 |
| 3 | 3 | | 47 28 11,2 2 1.85 1.10 .44 .08 | SIG-3-ACT-W55 | 25 |
| 4 | 4 | | 56 28 11,2 2 2.20 1.10 .44 .08 | SIG-4-ACT-W55 | 25 |
| 5 | 5 | | 69 28 11,2 2 2.72 1.10 .44 .08 | SIG-5-ACT-W55 | 25 |

