

**SAE Flange Adaptor with Male Metric Thread and 24° Conical Bore (acc. to ISO 8434-1)  
Type CAG-L/S ▪ 3000 PSI Series**

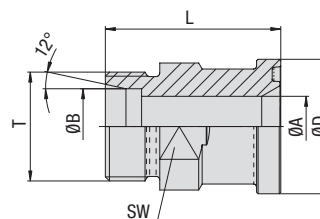

3000 PSI Standard Pressure Series (according to ISO 6162-1:2012)

Nominal Size	DN	(in)	PN <sup>1</sup> (bar/PSI)	Dimensions (mm/in)		Series	ØD	L	SW	T (Metric)	Weight (kg/lbs) ca. per 100	Ordering Codes
				10.9	ØA							
13	1/2		350	12	15	L	30,2	48	24	22x1,5	12,6	CAG-301-15L-W66
			5075	.47	.59		1.19	1.89	.94		27.72	
13	1/2		350	12	16	S	30,2	50	24	24x1,5	13,0	CAG-301-16S-W66
			5075	.47	.63		1.19	1.97	.94		28.60	
19	3/4		350	15	18	L	38,1	53	30	26x1,5	23,1	CAG-302-18L-W66
			5075	.59	.71		1.50	2.09	1.18		50.71	
19	3/4		350	16	20	S	38,1	57	30	30x2	24,2	CAG-302-20S-W66
			5075	.63	.79		1.50	2.24	1.18		53.24	
19	3/4		250	19	22	L	38,1	53	30	30x2	20,1	CAG-302-22L-W66
			3625	.75	.87		1.50	2.09	1.18		44.11	
19	3/4		350	17	25	S	38,1	57	30	36x2	25,6	CAG-302-25S-W66
			5075	.67	.98		1.50	2.24	1.18		56.36	
19	3/4		160	19	28	L	38,1	53	30	36x2	21,7	CAG-302-28L-W66
			2320	.75	1.10		1.50	2.09	1.18		47.81	
25	1		345	20	25	S	44,45	58	36	36x2	34,5	CAG-303-25S-W66
			5003	.79	.98		1.75	2.28	1.42		75.90	
25	1		250	24	28	L	44,45	54	36	36x2	28,3	CAG-303-28L-W66
			3625	.94	1.10		1.75	2.13	1.42		62.26	
25	1		345	24	30	S	44,45	63	36	42x2	35,2	CAG-303-30S-W66
			5003	.94	1.18		1.75	2.48	1.42		77.44	
32	1-1/4		280	20	25	S	50,8	60	41	36x2	46,6	CAG-304-25S-W66
			4061	.79	.98		2.00	2.36	1.61		102.52	
32	1-1/4		250	22	28	L	50,8	59	41	36x2	43,5	CAG-304-28L-W66
			3625	.87	1.10		2.00	2.32	1.61		95.80	
32	1-1/4		280	25	30	S	50,8	62	41	42x2	44,8	CAG-304-30S-W66
			4061	.98	1.18		2.00	2.44	1.61		98.56	
32	1-1/4		250	30	35	L	50,8	58	41	45x2	35,9	CAG-304-35L-W66
			3625	1.18	1.38		2.00	2.28	1.61		78.98	
32	1-1/4		280	28	38	S	50,8	67	46	52x2	54,4	CAG-304-38S-W66
			4061	1.10	1.50		2.00	2.64	1.81		119.68	
38	1-1/2		210	32	38	S	60,35	70	46	52x2	62,3	CAG-305-38S-W66
			3045	1.26	1.50		2.38	2.76	1.81		137.06	
38	1-1/2		210	36	42	L	60,35	64	46	52x2	47,7	CAG-305-42L-W66
			3045	1.42	1.65		2.38	2.52	1.81		104.90	

Please see Page 89 for separate Bolt Sets and Sealings.

**Materials / Ordering Options / Examples**

- \* SAE Flange Adaptor (without O-ring) made of Steel S355J2 or equivalent, zinc-plated and thick-film-passivated **CAG-...-...-W66**
- \* SAE Flange Adaptor (without O-ring) made of Steel S355J2 / C45 or equivalent, zinc/nickel-plated (on request) **CAG-...-...-W3**
- \* SAE Flange Adaptor (without O-ring) made of Stainless Steel V4A – 1.4571 (on request) **CAG-...-...-W5**
  
- \* Kit with DB including Metric bolts 10.9, spring rings, O-ring made of NBR (Buna-N®) **CAG-...-...-W130-K**
- \* Kit with DB including Metric bolts 10.9, spring rings, O-ring made of FKM (Viton®) **CAG-...-...-V-W130-K**
- \* Kit with DB including UNC bolts (Grade 8), spring rings, O-ring made of NBR (Buna-N®) **CAG-...-...-U-W130-K**

Please always indicate ØB and Series.

<sup>1</sup> The maximum working pressure PN (bar/PSI) applies only to the flange itself and depends on the bolts used (Grade 10.9). The actual maximum working pressure depends on the thickness and the quality of the tube used.