

CV45

3/2 Solenoid Poppet Valve (Directly actuated)

- Port size: Ø 14,3 mm
- Temperature up to +125°C
- Robust over-mould design
- Suitable for use with push in cartridge fittings/blanking plug accessories
- TYCO HDSCS
- IP 69K
- Any orientation operation
- Option to stack valves with use of O-ring accessory
- Vibration to ISO 16750-3 (2007)
- Example applications: Differential lock, exhaust brake, horn signal, axle lift etc.



Technical features

Medium:

Compressed air lubricated or non-lubricated

Operation:

Solenoid direct operated poppet valve - Normally Closed

Inlet pressure:

5 ... 10 bar (72 ... 145 psi)

Outlet pressure:

0 ... 10 bar (0 ... 145 psi)

Orifice:

2 or 3 mm

Port size:

Ø 14,3 mm x5° nominal
at 8 mm from port opening

Exhaust port:

IP69 rating

Operating temperature:

2 mm orifice
-25 ... +125°C (-13 ... +257°F)
3 mm orifice
-40 ... +85°C (-40 ... +185°F)
Air supply must be dry enough
to avoid ice formation at
temperatures below +2°C (+35°F)

Materials:

Valve base: PA glassfilled
Coil: Copper wire
Internal parts: Stainless steel
Seals: NBR/FPM

Technical data – solenoid operators

Nominal voltages	24 V d.c.
Duty cycle	100% ED
Protection diodes	1 x freewheeling, 1 x reverse polarity
Valve electrical connection mates with	T.E. connector 1-1418448-2

Technical data - standard options

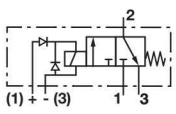
Symbol	Orifice (mm)	Power consumption (24 V @ 20°C coil temperature) (W)	No. of inserts	Flow rate @ 2 bar (20°C)		Weight (kg)	Model
				P1 » P2 (l/min)	P2 » P3 (l/min)		
	Ø 2	3,5	4	80	100	0,4	90-22327
	Ø 3	10	4	140	110	0,4	90-22295

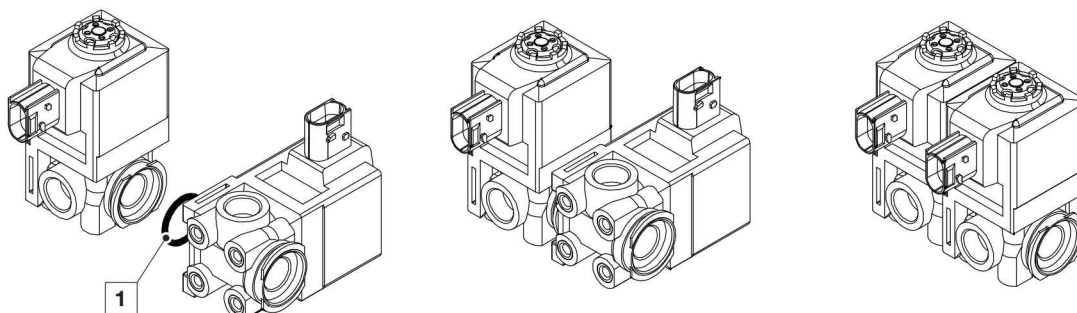

1 O-ring accessory (90-21978)

Accessories



Dimensions

Valve

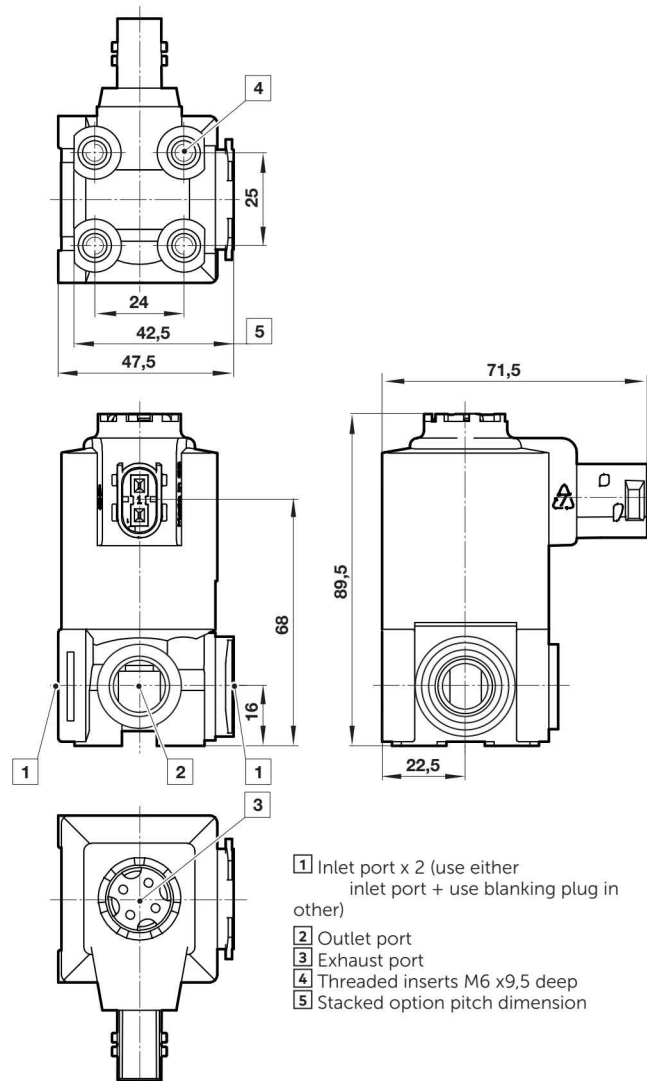

Use as single or stackable options

Option 1: Use as a single valve, need to use blanking plug (push in) accessory for one of the inlet ports.

Option 2: Use stacked together, need to use O-ring accessory to provide seal, plus relevant fitting accessories.

Dimensions in mm
Projection/First angle

Fitting details for guidance

Please refer to the fitting data sheets en 9.1.068 for details

Straight adaptor A1329-06N

Straight adaptor A1221-01

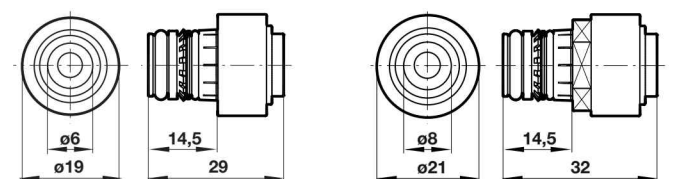

Blanking plug A1221-03

Elbow adaptor A1329-06

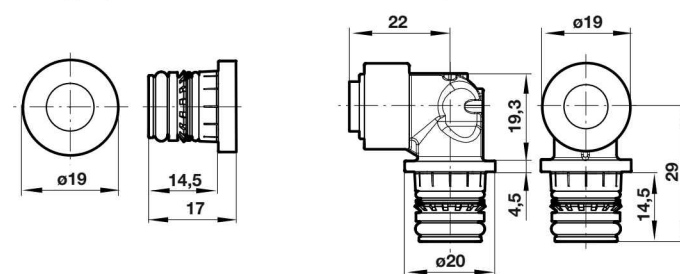

Adaptor/plug assembly instruction (assembly tools are available on request)
For guidance only!

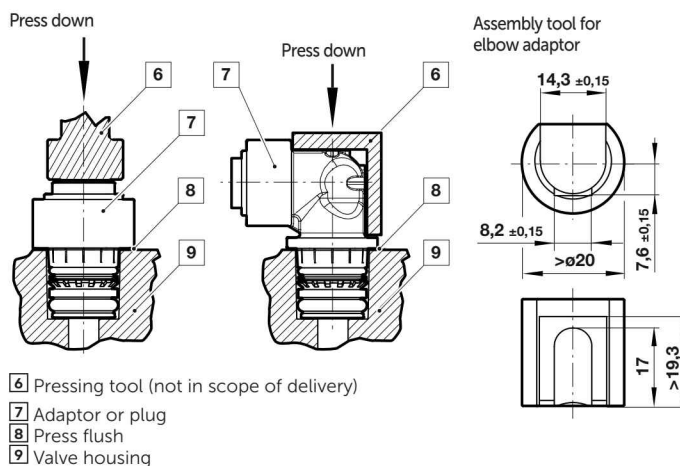

Warning

These products are intended for use in industrial compressed air systems only. Do not use these products where pressures and temperatures can exceed those listed under »Technical features/data«.

Before using these products with fluids other than those specified, for non-industrial applications, life-support systems or other applications not within published specifications, consult Norgren.

Through misuse, age, or malfunction, components used in fluid power systems can fail in various modes.

The system designer is warned to consider the failure modes of all component parts used in fluid power systems and to provide adequate safeguards to prevent personal injury or damage to equipment in the event of such failure.

System designers must provide a warning to end users in the system instructional manual if protection against a failure mode cannot be adequately provided.

System designers and end users are cautioned to review specific warnings found in instruction sheets packed and shipped with these products.