

Stainless Steel AISI 316-L

1/1

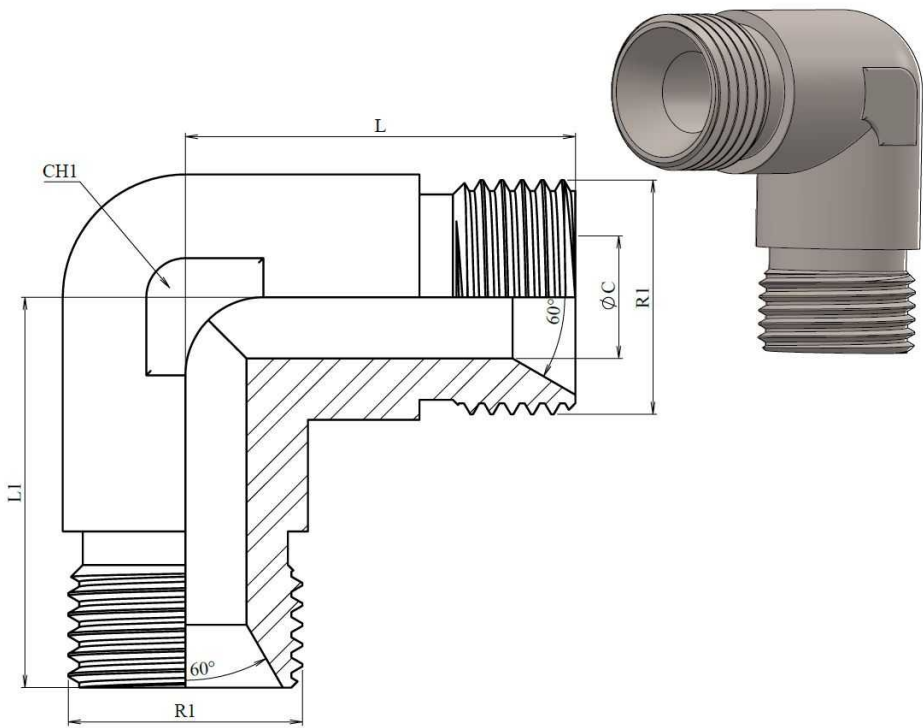

Part nº	R1	R2	L	L1	CH1	ØC
Z1190002	1/8" BSP	1/8" BSP	20	20	10	3,5
Z1190004	1/4" BSP	1/4" BSP	26	26	14	6
Z11900604	3/8" BSP	1/4" BSP				
Z1190006	3/8" BSP	3/8" BSP	30	30	17	8
Z1190008	1/2" BSP	1/2" BSP	35	35	22	11
Z1190012	3/4" BSP	3/4" BSP	44	44	28	16
Z1190016	1" BSP	1" BSP	45,5	45,5	36	22
Z1190020	1"1/4 BSP	1"1/4 BSP	52	52	46	28,5
Z1190024	1"1/2 BSP	1"1/2 BSP	60	60	50	32