



Type DV1



Flush-Type Grease Fittings

- without collar, with slot for screwdriver
- for even mounting without projection
- straight version A/180°
- made of steel, zinc-plated, passivated and top coated
- salt spray resistance > 72 hours

GW 1/8" NPTF		Ref.- No.:	
L1	L2	Steel	Alemite
23/64"	19/64"	5546124	1815
17/32"		5546126	1452

GW 1/4" NPTF		Ref.- No.:	
L1	L2	Steel	Alemite
9/16"		5546128	Z741-A

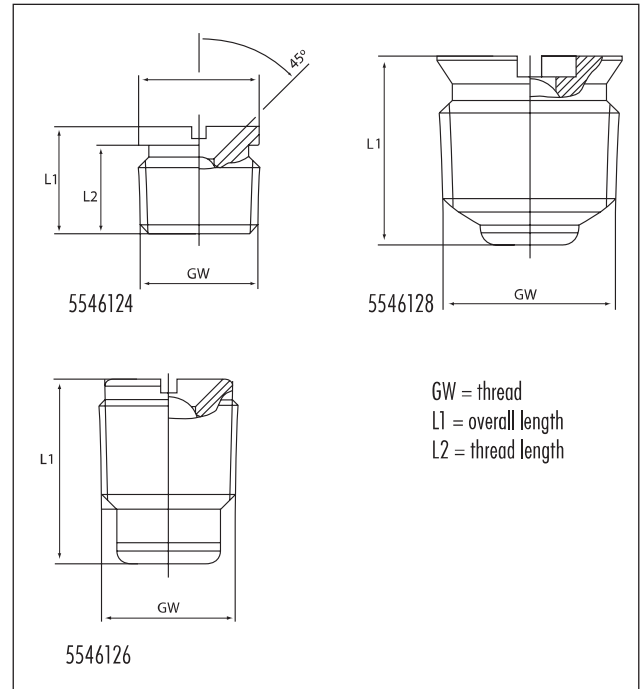

UMETA BUTTON-HEAD GREASE FITTINGS ACCORDING TO SAE J-534

Type M1



Button-Head Grease Fittings

- head Ø 15.5 mm (5/8")
- according to SAE J-534
- straight version A/180°
- standard versions according to SAE are made of steel, hardened, zinc plated, passivated and top coated
- salt spray resistance > 72 hours

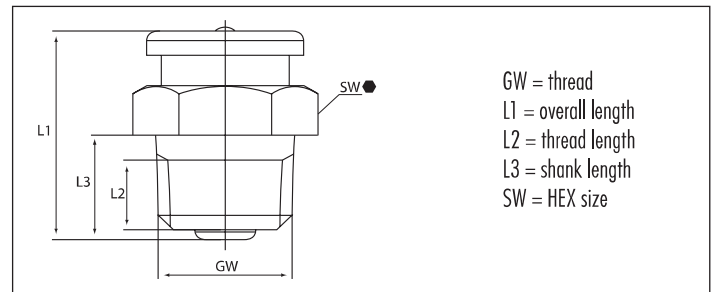

GW 1/8" PTF				Ref.- No.:		
L1	L2	L3	SW	Steel	SST303	Alemite
3/4"	3/16"	11/32"	5/8" HEX	5546112		1184-B

GW 1/4" NPTF				Ref.- No.:		
L1	L2	L3	SW	Steel	SST303	Alemite
53/64"	17/64"	27/64"	5/8" HEX	5546114		A1186
53/64"	17/64"	27/64"	5/8" HEX	5546116		1186-B

Type M1 according to ISO 2768-m - stainless steel

Button-Head Grease Fittings

- head Ø 15.5 mm (5/8")
- according to ISO 2768 - m
- straight version A/180°
- made of stainless steel 1.4305 ~ ASTM 303 (V2A)

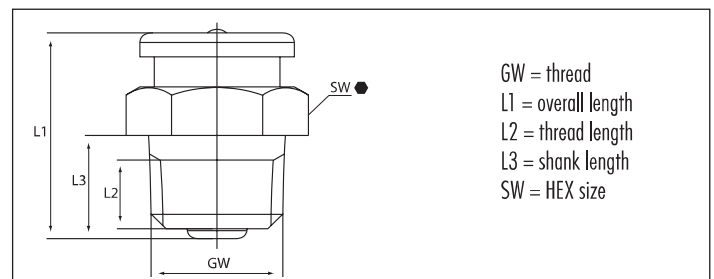

GW 1/8" PTF				Ref.- No.:		
L1	L2	L3	SW	Steel	SST303	Alemite
18 mm	4.8 mm	7.5 mm	17 mm HEX	5547020		-

GW 3/8" NPTF				Ref.- No.:		
L1	L2	L3	SW	Steel	SST303	Alemite
23.5 mm	13 mm	13 mm	19 mm HEX	5547022		-

GW 1/4" - 18 NPTF				Ref.- No.:		
L1	L2	L3	SW	Steel	SST303	Alemite
21 mm	6.75 mm	10.7 mm	17 mm HEX	5547021		-

*with plunger check