

BSP Swept 90° elbow 60° cone

Mild Steel

1/1

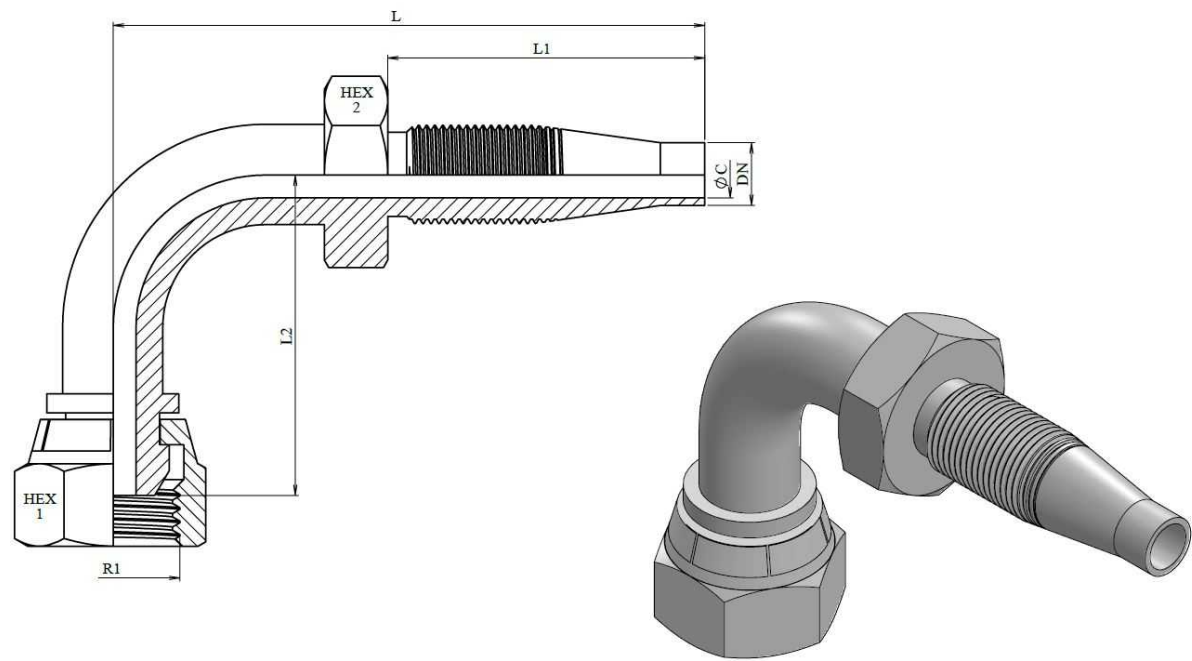

Part n°	DN	R1	R2	L	L1	L2	HEX 1	HEX 2	ØC
A90G-4	1/4"	1/4" BSP	7/16" 20h UNF	70	43	36	12	17	4
A90G-6	3/8"	3/8" BSP	9/16" 18h UNF	80	48	42	22	22	7
A90G-8	1/2"	1/2" BSP	5/8" 18h UNF	88	50	51	27	27	8
A90G-12	3/4"	3/4" BSP	M22x1,5	112	63	70	32	32	14
A90G-16	1"	1" BSP	29,9 16h UNF	132	71	71	41	41	19