

## BALL-TYPE GREASE NIPPLES - DRIVE-IN VERSION

### APPLICATION AREA

By using grease nipples with drive-in shank, you effectively save the thread-cutting process in the borehole.

### VERSIONS

Drive-in nipples as standard version are with plain shank, made of steel, zinc-plated and passivated. Upon request, manufactures drive-in grease nipples in other versions, with respect to the following:

- dimension
- material
- shank length
- shank type (e. g. serrated ridge)
- shank diameter
- surface colour
- further surface treatment

### MOUNTING INSTRUCTIONS

For straight-type grease nipples, we recommend using the drive-in tool, with which the nipple can

be driven-in effectively and with care.

The exact size of the core hole depends on the material and must be determined by mounting tests.

The standard gauge for the installation bore diameter corresponds to the nominal width of the shank  $\varnothing$ .



Drive-in tool

### OPERATING INSTRUCTIONS

Since this type of grease nipple is only driven in, it may get loose by

- strong vibrations
- high back-pressure when greasing with automatic guns
- pulling off the hydraulic coupler.

Drive-in type hydraulic grease nipples should only be lubricated by a hydraulic nozzle.



### RECOMMENDATION

Drive-in type grease nipples are only suitable for low pressures. Please check whether they can be replaced by self-forming nipples for a better fit.



## Type K1a

### Ball-Type Grease Nipples - Drive-in Version



- according to former DIN 3402
- straight version A/180°
- drive-in-type with plain shank
- standard versions according to DIN are made of steel, zinc-plated and passivated
- for other types and materials, please see table, or upon request

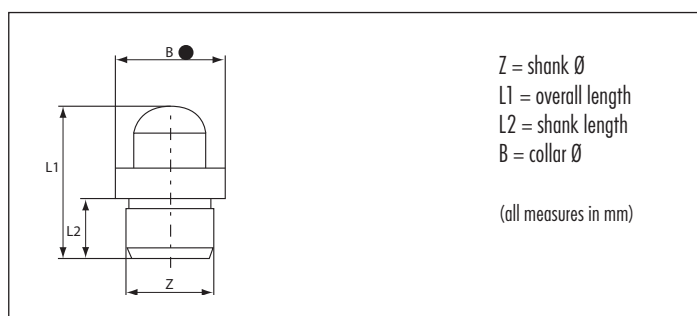

Z	6mm $\varnothing$	Ref.- No.:				
L1	L2	B	Steel	Brass	SST303	SST316L
14	5.5	8 ●	2100186	2110186	2120186	
15	6.5	8 ●		2110187		

Z	8mm $\varnothing$	Ref.- No.:				
L1	L2	B	Steel	Brass	SST303	SST316L
14	5.5	10 ●	2100288	2110288	2120288	

Z	10mm $\varnothing$	Ref.- No.:				
L1	L2	B	Steel	Brass	SST303	SST316L
14	5.5	12 ●	2100389			

**Type K2a****Ball-Type Grease Nipples - Drive-in Version**

- according to former DIN 3402
- angled version B/45°
- drive-in-type with plain shank
- standard versions according to DIN are made of steel, zinc-plated and passivated

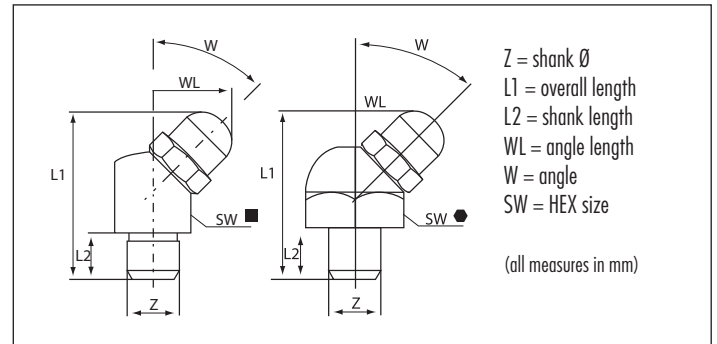
**Z 6mm Ø**

Ref.- No.:

L1	L2	WL	W	SW	Steel	Brass	SST303	SST316L
19	5.5	9	45°	9mm SQ. ■	2204586			
21	7	9	45°	9mm HEX ●		2111467		

**Z 10mm Ø**

Ref.- No.:

L1	L2	WL	W	SW	Steel	Brass	SST303	SST316L
19	5.5	9.5	45°	11mm SQ. ■	2204789			

**Z 8mm Ø**

Ref.- No.:

L1	L2	WL	W	SW	Steel	Brass	SST303	SST316L
19	5.5	9	45°	9mm SQ. ■	2204588			
21	7	9	45°	9mm HEX ●		2111466		

**Type K3a****Ball-Type Grease Nipples - Drive-in Version**

- according to former DIN 3402
- angled version C/90°
- drive-in-type with plain shank
- standard versions according to DIN are made of steel, zinc-plated and passivated

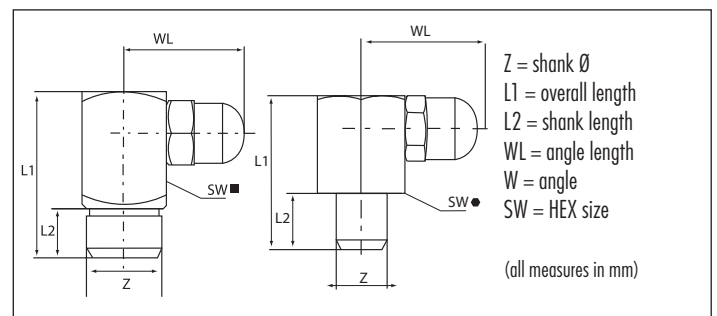
**Z 6mm Ø**

Ref.- No.:

L1	L2	WL	W	SW	Steel	Brass	SST303	SST316L
18	5.5	13	90°	9mm SQ. ■	2304586			
18	5.5	13	90°	9mm HEX ●		2111462		
19	5.5	13	90°	11mm HEX ●		2111463		

**Z 8mm Ø**

Ref.- No.:

L1	L2	WL	W	SW	Steel	Brass	SST303	SST316L
18	5.5	13	90°	9mm SQ. ■	2304588			
19	5.5	13	90°	11mm HEX ●		2111464		