

Pressure gauge DN 100 vertical connection

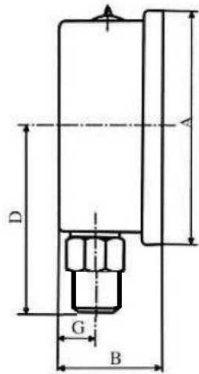
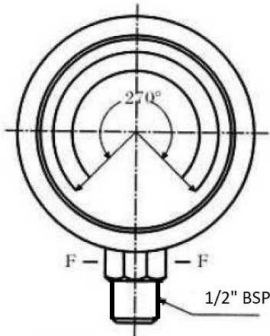

Accuracy: 1,6%

Dimensions: A=109
B=35,5
D=74
F=HEX 14
G=11,5

Temperature: from -10 up to +60

Fitting and internal components: Stainless steel 316L

Case: Stainless steel 304

Part nº	R2	Scale (bar)
ZMFI10008006V	1/2" BSP	0-6
ZMFI10008010V	1/2" BSP	0-10
ZMFI10008016V	1/2" BSP	0-16
ZMFI10008025V	1/2" BSP	0-25
ZMFI10008040V	1/2" BSP	0-40
ZMFI10008060V	1/2" BSP	0-60
ZMFI10008100V	1/2" BSP	0-100
ZMFI10008160V	1/2" BSP	0-160
ZMFI10008250V	1/2" BSP	0-250
ZMFI10008400V	1/2" BSP	0-400
ZMFI10008600V	1/2" BSP	0-600

With dual bar/psi scale
IP65