

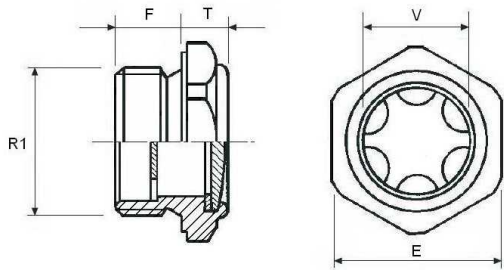

TLA...

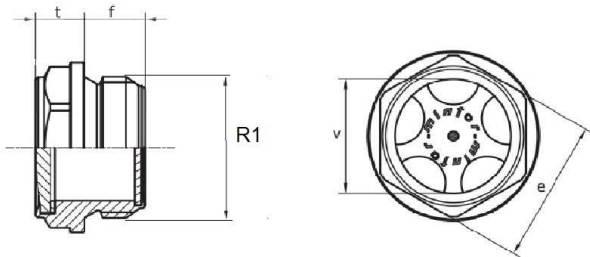

TLA F...



Visor: transparent polycarbonate

Part nº	R1	ØV	E	F	T
TLA1G	1/4" BSP	10	17	8	7
TLA6G	1"1/4 BSP	37	50	15	10
TLA7G	1"1/2 BSP	40	55	15	10
TLA8G	2" BSP	50	70	17	14
TLA/F1G	3/8" BSP	10	18	9.5	9
TLA/F2G	1/2" BSP	16	22	10.5	9
TLA/F3G	3/4" BSP	21	27	12	11
TLA/F4G	1" BSP	27	34	13.5	12
TLA/F5G	1"1/4 BSP	37	46	15	12

Max.press: 5 bar
Working temp.: -20 +100°C