

## FLUSH-TYPE GREASE NIPPLES - SPECIAL DESIGNS

### VERSIONS

The following types are representing only the most commonly used special-type nipples. For individual applications, manufactures flush-type grease nipples with special equipment in other versions, with respect to the following:

- dimension
- material
- thread size
- thread form (e. g. with tapered thread)
- length



### Type DV1

#### Flush-Type Grease Nipples

- without collar, with slot for screwdriver
- for even mounting without projection
- straight version A/180°
- made of steel, zinc-plated and passivated, with cylindrical thread



GW	M 8 x 1.0	Ref.- No.:			
L1		Steel	Brass	SST303	SST316L
10		5243010		5243069	5243021

GW	M 10 x 1.0	Ref.- No.:			
L1		Steel	Brass	SST303	SST316L
10		5243018		5243067	

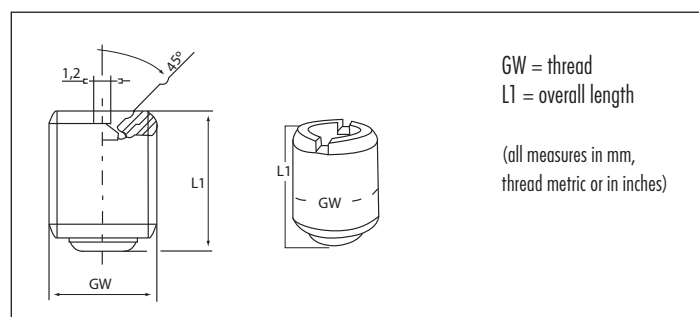

GW	G 1/8, 1/8 - 28 BSPP	Ref.- No.:			
L1		Steel	Brass	SST303	SST316L
10		5243019		5243068	

GW	G 1/4	Ref.- No.:			
L1		Steel	Brass	SST303	SST316L
13		5243020			

### Type D3 quattro 90°

#### Flush-Type Grease Nipples

- made of steel, zinc-plated and passivated, with tapered thread



GW	M 6 x 1.0	Ref.- No.:			
L1	L2	WL	W	SW	Steel Brass SST303 SST316L
15.5	5.5	33	90°	11mm SQ. ■	5244185

