

## Gauge Isolator Valve ▪ Type SWS-S1 (Single Station)

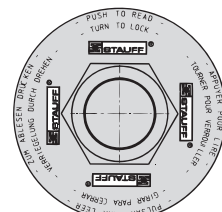
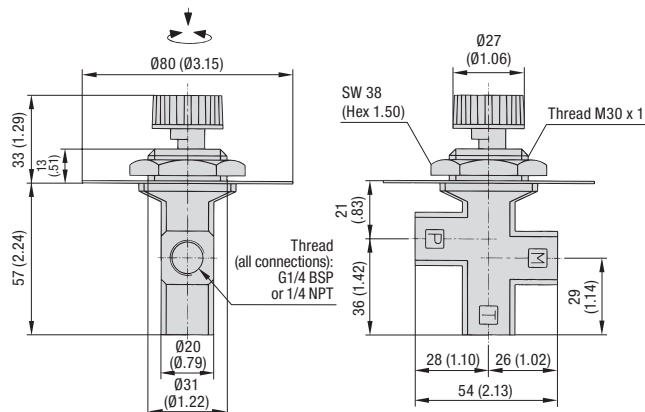

### Characteristics

Effective protection of pressure gauges against overload caused by pressure peaks

#### Features

- Suitable for panel installation
- Max. panel thickness of 5 mm / .20 in
- Fixed with hexagonal nut
- Push button to read and turn to lock
- Multilingual instructions printed on face plate

#### Media Compatibility

- Suitable for use with mineral and petroleum based hydraulic fluids (HL and HLP)

#### Materials

- Body made of Cast Iron
- Spindle made of Steel
- Push / turn button made of Polyamide (PA)
- Face plate made of Aluminium
- O-rings made of NBR (Buna-N®)

#### Technical Data

- Maximum working pressure: 400 bar / 5800 PSI
- Operating temperature range: -30 °C ... +115 °C / -22 °F ... +239 °F

Please contact STAUFF before using with other media

### Order Codes

SWS - S1 - G04		
①	②	③
<b>① Type</b>		
Gauge Isolator Valve		<b>SWS</b>
<b>② Style</b>		
Single station		<b>S1</b>
<b>③ Connection Thread</b>		
Female G1/4 BSP (for all connections)		<b>G04</b>
Female 1/4 NPT (for all connections)		<b>N04</b>

## Gauge Isolator Valve ▪ Type SWS-M (Multi Station)

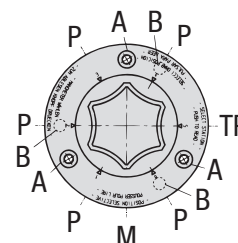
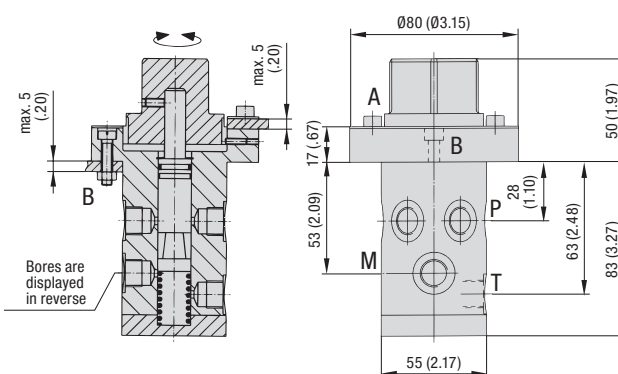
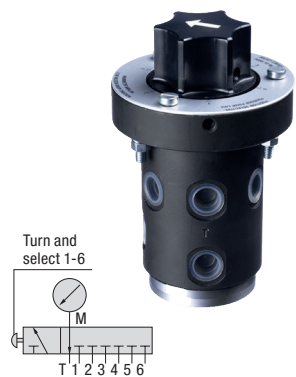

#### Mounting Bores (ø6 mm / .24 in)

- A** 3 bores, equally spaced (120°), BCD ø65 mm / 2.56 in
- B** 3 bores, equally spaced (120°), BCD ø65 mm / 2.56 in

#### Connections (G1/4 BSP or 7/16-20 UNF)

- P** 6 bores, equally spaced (60°)
- M** 1 bore
- T** 1 bore

### Characteristics

Pressure measurement on six positions in the hydraulic circuit with only one pressure gauge

#### Features

- Suitable for bulkhead installation
- Max. panel thickness of 5 mm / .20 in
- Fixed with connection flange and screws: 3 hexagon head bolts M5 x 10 (DIN 933) for mounting the printed panel and 3 socket cap screws M5 x 25 (DIN 912) with washers (DIN 127) and nut (DIN 934) for panel installation included in delivery
- Turn button to select position of measurement
- Multilingual instructions printed on panel

#### Media Compatibility

- Suitable for use with mineral and petroleum based hydraulic fluids (HL and HLP)

Please contact STAUFF before using with other media.

#### Materials

- Body made of Cast Iron
- Spindle made of Steel
- Push / turn button made of Polyamide (PA)
- Face plate and end cover made of Aluminium
- O-rings made of NBR (Buna-N®)

#### Technical Data

- Maximum working pressure: 400 bar / 5800 PSI
- Operating temperature range: -30 °C ... +115 °C / -22 °F ... +239 °F

#### Note:

All thread protection plugs must be removed before use. Unused connection threads P must be sealed tightly with a suitable screw plug (e.g. DIN 908). Screw plugs are not included in the scope of delivery.

### Order Codes

SWS - M - G04		
①	②	③
<b>① Type</b>		
Gauge Isolator Valve		<b>SWS</b>
<b>② Style</b>		
Multi station		<b>M</b>
<b>③ Connection Thread</b>		
Female G1/4 BSP for all connections		<b>G04</b>
Female 7/16-20 UNF (1/4" SAE) for all connections		<b>U04</b>