

Elbow Bulkhead Fittings  
Type FI-WS • Series L / S

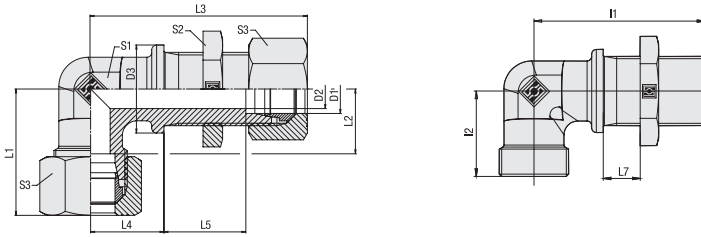

Series	Tube OD (mm/in)	PN (bar/PSI)	Dimensions (mm/in)													Weight (kg/lbs) ca. per 100	Ordering Codes <sup>3</sup>	
			D1	D2	L	i1	i2	L1 <sup>1</sup>	L2	L3 <sup>1</sup>	L4	L5	L7 <sub>min</sub>	L7 <sub>max</sub>	S1			S2
L	6	500	4	17	48	19	27	12	56	14	27	3	16	12	17	14	4,88	FI-WS-06L-W3-SKM
	.24	7252	.16	.67	1.89	.75	1.06	.47	2.20	.55	1.06	.12	.63	.47	.67	.55	10,74	
	8	500	6	19	51	21	29	14	59	17	27	3	16	12	19	17	6,11	FI-WS-08L-W3-SKM
	.31	7252	.24	.75	2.01	.83	1.14	.55	2.32	.67	1.06	.12	.63	.47	.75	.67	13,43	
	10	500	8	22	53	22	30	15	61	18	28	3	16	14	22	19	7,89	FI-WS-10L-W3-SKM
	.39	7252	.31	.87	2.09	.87	1.18	.59	2.40	.71	1.10	.12	.63	.55	.87	.75	17,35	
	12	400	10	24	56	24	32	17	64	20	29	3	16	17	24	22	9,65	FI-WS-12L-W3-SKM
	.47	5802	.39	.94	2.20	.94	1.26	.67	2.52	.79	1.14	.12	.63	.67	.94	.87	21,23	
	15	400	12	27	61	28	36	21	69	23	31	3	16	19	30	27	16,31	FI-WS-15L-W3-SKM
	.59	5802	.47	1.06	2.40	1.10	1.42	.83	2.72	.91	1.22	.12	.63	.75	1.18	1.06	35,88	
	18	400	15	32	64	31	40	23,5	73	24	32,5	3	16	24	36	32	23,82	FI-WS-18L-W3-SKM
	.71	5802	.59	1.26	2.52	1.22	1.57	.93	2.87	.94	1.28	.12	.63	.94	1.42	1.26	52,40	
	22	250	19	36	72	35	44	27,5	81	30	34,5	4	16	27	41	36	30,41	FI-WS-22L-W3-SKM
	.87	3626	.75	1.42	2.83	1.38	1.73	1.08	3.19	1.18	1.36	.16	.63	1.06	1.61	1.42	66,90	
	28	250	24	42	77	38	47	30,5	86	34	35,5	4	16	36	46	41	45,92	FI-WS-28L-W3-SKM
	1.10	3626	.94	1.65	3.03	1.50	1.85	1.20	3.39	1.34	1.40	.16	.63	1.42	1.81	1.61	101,03	
	35	250	30	50	86	45	56	34,5	97	39	36,5	4	16	41	55	50	75,00	FI-WS-35L-W3-SKM
	1.38	3626	1.18	1.97	3.39	1.77	2.20	1.36	3.82	1.54	1.44	.16	.63	1.61	2.17	1.97	165,00	
42	250	36	60	90	51	63	40	102	43	36	4	16	50	65	60	107,00	FI-WS-42L-W3-SKM	
1.65	3626	1.42	2.36	3.54	2.01	2.48	1.57	4.02	1.69	1.42	.16	.63	1.97	2.56	2.36	235,40		
S	6	800	4	19	53	23	31	16	61	17	29	3	16	12	19	17	7,34	FI-WS-06S-W3-SKM
	.24	11603	.16	.75	2.09	.91	1.22	.63	2.40	.67	1.14	.12	.63	.47	.75	.67	16,15	
	8	800	5	22	54	24	32	17	62	18	29	3	16	14	22	19	10,16	FI-WS-08S-W3-SKM
	.31	11603	.20	.87	2.13	.94	1.26	.67	2.44	.71	1.14	.12	.63	.55	.87	.75	22,35	
	10	800	7	24	57	25	34	17,5	66	20	29,5	3	16	17	24	22	12,59	FI-WS-10S-W3-SKM
	.39	11603	.28	.94	2.24	.98	1.34	.69	2.60	.79	1.16	.12	.63	.67	.94	.87	27,71	
	12	630	8	27	59	29	38	21,5	68	21	30,5	3	16	17	27	24	16,05	FI-WS-12S-W3-SKM
	.47	9137	.31	1.06	2.32	1.14	1.50	.85	2.68	.83	1.20	.12	.63	.67	1.06	.94	35,30	
	14	630	10	27	63	30	40	22	73	23	32	3	16	19	30	27	19,62	FI-WS-14S-W3-SKM
	.55	9137	.39	1.06	2.48	1.18	1.57	.87	2.87	.91	1.26	.12	.63	.75	1.18	1.06	43,17	
	16	630	12	30	64	33	43	24,5	74	24	31,5	3	16	24	32	30	24,14	FI-WS-16S-W3-SKM
	.63	9137	.47	1.18	2.52	1.30	1.69	.96	2.91	.94	1.24	.12	.63	.94	1.26	1.18	53,10	
	20	400	16	36	74	37	48	26,5	85	30	33,5	4	16	27	41	36	38,01	FI-WS-20S-W3-SKM
	.79	5802	.63	1.42	2.91	1.46	1.89	1.04	3.35	1.18	1.32	.16	.63	1.06	1.61	1.42	83,63	
	25	400	20	42	81	42	54	30	93	34	35	4	16	36	46	46	61,10	FI-WS-25S-W3-SKM
	.98	5802	.79	1.65	3.19	1.65	2.13	1.18	3.66	1.34	1.38	.16	.63	1.42	1.81	1.81	134,42	
	30	400	25	50	90	49	62	35,5	103	39	37,5	4	16	41	50	50	91,00	FI-WS-30S-W3-SKM
	1.18	5802	.98	1.97	3.54	1.93	2.44	1.40	4.06	1.54	1.48	.16	.63	1.61	1.97	1.97	200,20	
38	400	32	60	96	57	72	41	112	43	37	4	16	50	65	60	138,90	FI-WS-38S-W3-SKM	
1.50	5802	1.26	2.36	3.78	2.24	2.83	1.61	4.41	1.69	1.46	.16	.63	1.97	2.56	2.36	305,58		

<sup>1</sup> Approximate dimension in assembled condition.  
<sup>2</sup> Weight excluding cutting rings and union nuts.  
<sup>3</sup> Standard scope of delivery: Fitting body only.

### Ordering Codes

**\*FI-WS\*-10\*L\*-W3\*-MS**

- \* Elbow Bulkhead Fitting **FI-WS**
- \* Outside Tube Diameter D1 (in mm) **-10**
- \* Series Light Series **L**  
Heavy Series **S**
- \* Material Code Steel, zinc/nickel-plated **-W3**

Please contact STAUFF for alternative materials and surface finishings.

\* Assembling / Kitting Fitting body only **—**

Fitting body supplied with hexagon lock nut **-SKM**

Fitting body supplied with cutting rings and union nuts **-MS**

Fitting body supplied with soft-sealing cutting rings and union nuts **-MSV**

### Connecting Parts

- Cutting Ring Type **FI-DS** Page 28
- Soft-Sealing Cutting Ring Type **FI-WDDS** Page 29
- Support Sleeve Type **FI-VH** Page 31
- STAUFF Form EVO Sealing Ring Type **FI-FD** Page 32
- Union Nut Type **FI-M** Page 33
- 37° Flared Tube Fitting Set Type **FI-AB** Page 37

### Spare Parts / Accessories

- Hexagon Lock Nut Type **FI-SKM** Page 237

E

