

ACCESSORIES & AIR GUNS SILENCERS

PLUS

**WIDE TEMPERATURE RANGE
THANKS TO MULTIPLE
CONSTRUCTION MATERIALS**

**FILTRATION DEGREES BETWEEN 5
AND 120 NM RESULT SUITABLE FOR
PNEUMATIC APPLICATIONS**

**CONSTRUCTION QUALITY
GUARANTEED BY RAW MATERIALS
USED AND THE METICOLEOUS
CONTROLS PERFORMED**

**EXCELLENT NOISE REDUCTION IN
AUTOMATIC SYSTEMS**

**ALSO USED FOR SAFETY
APPLICATIONS IN PNEUMATIC
EQUIPMENT**



					
p. 428 / 6100	p. 428 / 6150	p. 428 / 6200	p. 428 / 6250	p. 429 / 6300	p. 429 / 6350
					
p. 429 / 6400	p. 429 / 6450	p. 430 / 6500	p. 430 / 6550	p. 430 / 6600	p. 430 / 6650
					
p. 431 / 6655	p. 431 / 6670	p. 431 / 6700	p. 431 / 6750	p. 432 / 6780	p. 432 / 6820
					
p. 432 / 6850	p. 432 / 6880	p. 433 / 6882	p. 433 / 6885		



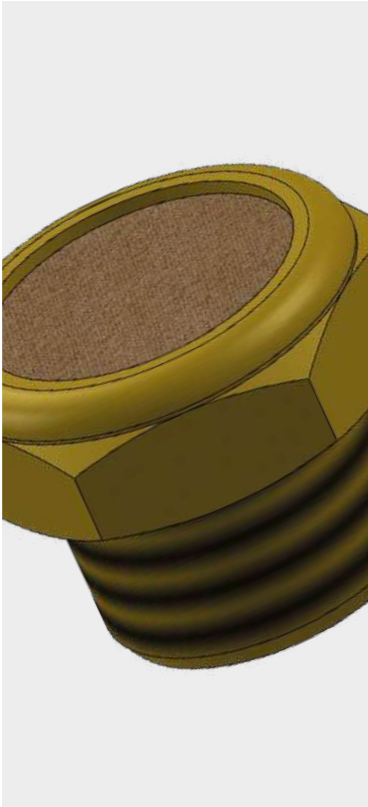

- 20°C ÷ 80°C
- 10°C ÷ 80°C (6650)
- 10°C ÷ 50°C (6700 & 6750)
- 40°C ÷ 200°C (6885)
- 20°C ÷ 300°C (6880 & 6882)



- Working pressure:**
- 10 Bar
 - 6 Bar (6700, 6750 and 6780)



- Compressed air

NOISE LEVEL

Noise level in dB 4 & 6 Bar, indicated in the tables.



- Parallel gas BSPP ISO 228 from G1/8" to G1"
- Metric ISO 262 M5
- NPT from N1/8" to N1"



- 6100, 6150, 6550, 6600: Sintered spherical bronze on copper-plated steel hexagonal base
- 6200, 6250, 6300, 6350, 6400, 6650, 6670: Sintered spherical bronze on brass hexagonal base
- 6420, 6500: Stainless steel AISI 304 wire on brass base
- 6700, 6750: Acetal resin
- 6780, 6655: Polyethylene
- 6820: Stainless steel AISI 304 wire on nylon base
- 6850: Stainless steel AISI 304
- 6885: Stainless steel AISI 316
- 6880, 6882: Stainless steel AISI 316L



Products in compliance with EC Regulation 1907/2006



Products in compliance with the directive EU 2015/863

FEATURES

Silencers are use to reduce the noise levels in a pneumatic system, silencing the discharges of compressed air in the environment and reducing the valves noise during the operation.



6100

Sintered spherical bronze cone silencer on copper-plated steel hexagonal base

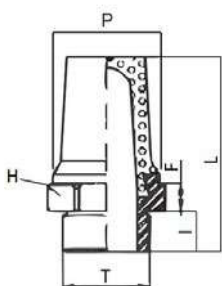

CODE	T	P	I	F	L	H	dB 4 Bar	dB 6 Bar	g
6100TRM5	M5x0,8	5,5	3,5	4,0	17,0	7	-	-	2,0
6100TR18	G 1/8"	10,5	4,5	3,8	21,0	12	76	79	6,0
6100TR14	G 1/4"	12,5	6,0	4,5	27,0	15	75	78	12,5
6100TR38	G 3/8"	17,0	7,0	5,4	35,0	19	81	82	23,0
6100TR12	G 1/2"	20,5	8,0	6,0	41,5	23	84	85	39,0
6100TR34	G 3/4"	26,5	9,0	7,5	54,0	30	90	94	78,5
6100TR1	G 1"	33,0	11,0	9,0	66,0	36	92	95	149,5

6150

Sintered spherical bronze silencer with hexagonal cone on round copper-plated steel base

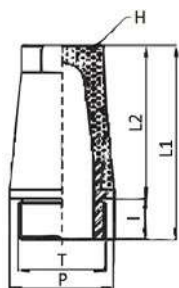

CODE	T	P	I	L1	L2	H	dB 4 Bar	dB 6 Bar	g
6150TR18	G 1/8"	11,5	4,5	22,5	18,0	8	77	80	6,5
6150TR14	G 1/4"	15,0	6,0	28,5	23,5	10	76	79	12,5
6150TR38	G 3/8"	19,0	7,0	36,0	29,0	13	82	83	23,5
6150TR12	G 1/2"	23,0	8,0	44,0	36,0	15	84	85	39,0
6150TR34	G 3/4"	30,0	9,0	56,0	47,0	19	91	95	77,5
6150TR1	G 1"	37,0	11,0	69,0	58,0	24	92	95	139,0

6200

Sintered spherical bronze silencer with rebated cone on brass hexagonal base

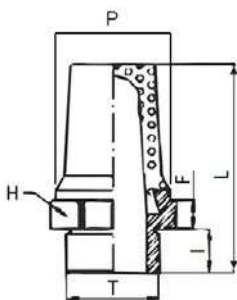

CODE	T	P	I	F	L	H	dB 4 Bar	dB 6 Bar	g
6200TRM5	M5x0,8	4,0	3,5	3,0	17,0	8	-	-	2,5
6200TR18	G 1/8"	8,5	6,0	4,0	26,0	13	70	75	9,5
6200TR14	G 1/4"	10,5	8,0	5,0	34,0	16	75	81	16,5
6200TR38	G 3/8"	13,0	8,0	5,0	41,0	19	78	82	26,5
6200TR12	G 1/2"	18,0	10,0	6,0	46,0	24	81	85	46,5
6200TR34	G 3/4"	25,5	10,0	6,0	56,0	30	83	-	81,5
6200TR1	G 1"	30,5	10,0	6,0	66,0	36	84	-	134,0

6250

Sintered spherical bronze silencer with hexagonal cone head rebated on circular brass base

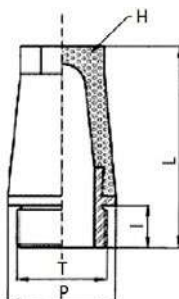

CODE	T	P	I	L	H	dB 4 Bar	dB 6 Bar	g
6250TR18	G 1/8"	13,0	7,0	27,0	6,0	70	75	8,5
6250TR14	G 1/4"	16,0	8,0	30,0	7,0	75	81	13
6250TR38	G 3/8"	19,0	8,0	40,0	10,0	78	82	23
6250TR12	G 1/2"	24,0	10,0	46,0	13,0	81	85	40
6250TR34	G 3/4"	30,0	10,0	54,0	17,0	83	-	73,5
6250TR1	G 1"	38,0	10,0	61,0	22,0	84	-	145



6300

Sintered spherical bronze silencer with riveted pastille on brass hexagonal base

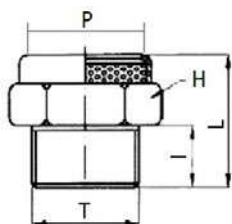

CODE	T	P	I	L	H	dB 4 Bar	dB 6 Bar	g
6300TRM5	M5x0,8	5,0	4,0	8,5	8	-	-	2,0
6300TR18	G 1/8"	9,0	6,0	12,0	13	70	73	6,5
6300TR14	G 1/4"	11,0	8,0	16,0	16	71	74	11,0
6300TR38	G 3/8"	14,0	8,0	17,0	19	83	85	16,5
6300TR12	G 1/2"	19,0	10,0	18,0	24	85	89	26,0
6300TR34	G 3/4"	25,0	10,0	19,0	30	87	89	39,5
6300TR1	G 1"	31,0	10,0	20,0	36	87	90	60,0

6350

Sintered spherical bronze silencer with riveted pastille on circular knurled brass base

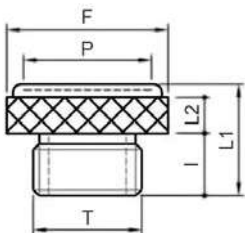

CODE	T	P	F	I	L1	L2	dB 4 Bar	dB 6 Bar	g
6350TR18	G 1/8"	8,0	13,0	7,0	13,0	4,0	70	73	7,0
6350TR14	G 1/4"	12,0	16,0	8,0	16,0	4,5	71	74	7,0
6350TR38	G 3/8"	15,0	19,0	8,0	14,0	5,0	83	85	10,0
6350TR12	G 1/2"	19,0	24,0	10,0	18,0	5,0	85	89	10,0
6350TR34	G 3/4"	24,0	30,0	10,0	18,0	5,0	87	89	12,0
6350TR1	G 1"	30,0	38,0	10,0	19,0	6,0	87	90	12,0

6400

Sintered spherical bronze silencer with rebated cone on circular knurled brass base

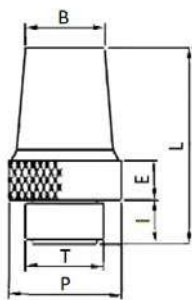

CODE	T	P	I	B	E	L	dB 4 Bar	dB 6 Bar	g
6400TR18	G 1/8"	13,0	7,0	8,5	4,0	27,0	70	75	9
6400TR14	G 1/4"	16,0	8,0	11,0	4,5	34,0	75	81	13,5
6400TR38	G 3/8"	19,0	8,0	14,0	5,0	41,0	78	82	23
6400TR12	G 1/2"	24,0	10,0	17,0	5,0	46,0	81	85	45
6400TR34	G 3/4"	30,0	10,0	21,0	5,0	56,0	83	-	80
6400TR1	G 1"	38,0	10,0	26,5	6,0	66,0	84	-	133,5

6450

Silencer with stainless steel AISI 304 wire mesh on brass hexagonal base

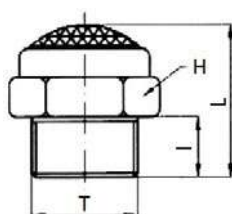

CODE	T	I	L	H	dB 4 Bar	dB 6 Bar	g
6450TRM5	M5x0,8	4,0	8,8	8,0	-	-	1,5
6450TR18	G 1/8"	6,0	15,0	13,0	70	74	6,0
6450TR14	G 1/4"	8,0	18,0	16,0	69	72	10,5
6450TR38	G 3/8"	8,0	20,0	19,0	85	88	16,5
6450TR12	G 1/2"	10,0	22,0	24,0	85	90	24,5
6450TR34	G 3/4"	10,0	26,0	30,0	86	90	37,0
6450TR1	G 1"	10,0	28,0	36,0	88	92	56,5



6500

Silencer with stainless steel AISI 304 wire mesh on circular knurled brass base

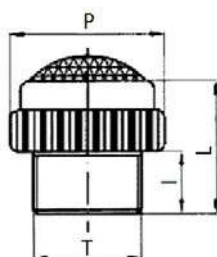

CODE	T	P	I	L	dB 4 Bar	dB 6 Bar	g
6500TR18	G 1/8"	13,0	7,0	14,0	70	74	5
6500TR14	G 1/4"	16,0	8,0	18,0	69	72	8,5
6500TR38	G 3/8"	19,0	8,0	20,0	85	88	13,5
6500TR12	G 1/2"	24,0	10,0	22,0	85	90	23,5
6500TR34	G 3/4"	30,0	10,0	24,0	86	90	30,5
6500TR1	G 1"	38,0	10,5	27,0	88	92	57,5

6550

Sintered spherical bronze cone silencer on circular copper-plated steel base

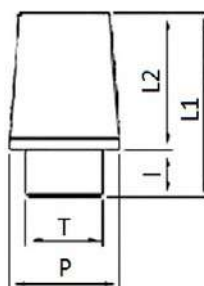

CODE	T	P	I	L1	L2	dB 4 Bar	dB 6 Bar	g
6550TR18	G 1/8"	11,5	4,5	21,0	16,5	68	60	6,0
6550TR14	G 1/4"	15,0	6,0	25,0	19,0	65	67	11,5
6550TR38	G 3/8"	19,0	7,0	34,5	27,5	74	77	24,0
6550TR12	G 1/2"	23,0	8,0	43,0	35,0	76	80	44,5
6550TR34	G 3/4"	30,0	9,0	50,0	41,0	80	84	73,0
6550TR1	G 1"	37,0	11,0	60,5	49,5	82	85	137,5

6600

Sintered spherical bronze silencer with screwdriver-cut cone on round copper-plated steel base

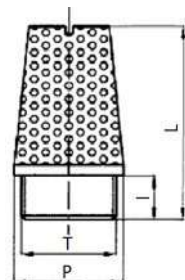

CODE	T	P	I	L	dB 4 Bar	dB 6 Bar	g
6600TR18	G 1/8"	11,5	4,5	22,0	68	70	6,0
6600TR14	G 1/4"	15,0	6,0	26,0	65	67	13,0
6600TR38	G 3/8"	19,0	7,0	34,5	75	77	24,5
6600TR12	G 1/2"	23,0	8,0	43,0	76	80	42,0
6600TR34	G 3/4"	30,0	9,0	50,0	80	84	75,0
6600TR1	G 1"	37,0	11,0	60,5	82	85	136,0

6650

Regulated silencer with sintered bronze pastille

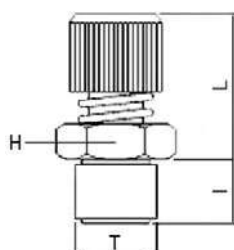

CODE	T	L MIN	L MAX	I	H	dB 4 Bar	dB 6 Bar	g
6650TR18	G 1/8"	20,0	22,0	6,0	13	69	72	16,0
6650TR14	G 1/4"	22,0	24,0	8,0	15	70	73	23,0
6650TR38	G 3/8"	25,0	28,0	10,0	22	82	84	48,0
6650TR12	G 1/2"	26,0	29,0	11,0	22	84	88	59,0



6655

Silencer with a regulated flow in polyethylene

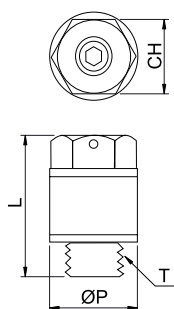

CODE	T	ØP	L	CH	dB 4 Bar	dB 6 Bar	g
6655TR18	G 1/8"	15	20,5	13	-	-	3,0
6655TR14	G 1/4"	18	29,0	15	-	-	6,0
6655TR38	G 3/8"	24	28,0	20	-	-	18,0
6655TR12	G 1/2"	30	50,0	25	-	-	45,0

6670

Sintered spherical bronze silencer with screwdriver

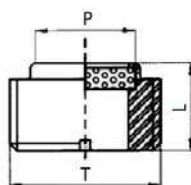

CODE	T	ØP	L	dB 4 Bar	dB 6 Bar	g
6670TR18	G 1/8"	6,0	5,0	69	72	1,37
6670TR14	G 1/4"	8,0	6,0	70	73	2,91
6670TR38	G 3/8"	10,0	7,0	82	84	6,33
6670TR12	G 1/2"	15,0	8,0	84	88	11,69
6670TR34	G 3/4"	20,0	9,0	85	88	14,56
6670TR1	G 1"	26,0	10,0	85	89	28,26

6700

Dynamic acetal resin silencer with balls

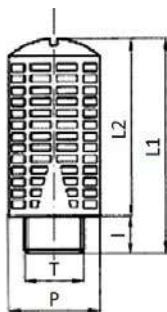

CODE	T	P	I	L1	L2	dB 4 Bar	dB 6 Bar	g
6700TR18	G 1/8"	15	6	32,5	26,5	84	87	4,0
6700TR14	G 1/4"	19,5	8	43	35	81	84	8,0
6700TR38	G 3/8"	24,5	11	58	47	83	90	18,0
6700TR12	G 1/2"	24,5	11	58	47	83	90	19,0
6700TR34	G 3/4"	48	18	115	97	85	91	115,0
6700TR1	G 1"	48	18	115	97	85	90	115,0

6750

Static acetal resin silencer with felt inside

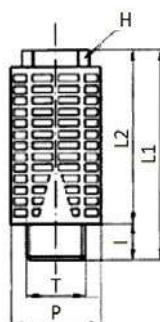

CODE	T	P	I	L1	L2	H	dB 4 Bar	dB 6 Bar	g
6750TR18	G 1/8"	16	6	34	28	10	85	87	4,0
6750TR14	G 1/4"	19	8	44	36	12	86	90	7,0
6750TR38	G 3/8"	24	10	56	47	16	87	92	14,0
6750TR12	G 1/2"	24	10	56	47	16	87	92	15,0



6780

Polyethylene silencer

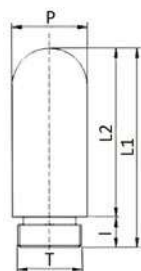

CODE	T	ØP	I	L1	L2	g
6780TRM5	M5x0,8	7,0	4,0	24,5	20,5	2,8
6780TR18	G 1/8"	13,0	7,5	32,5	25,0	3,7
6780TR14	G 1/4"	17,0	8,0	39,0	31,0	10,0
6780TR38	G 3/8"	25,0	11,0	65,0	54,0	13,5
6780TR12	G 1/2"	25,0	11,0	69,0	58,0	37,0
6780TR34	G 3/4"	37,0	15,5	138,0	122,5	47,0
6780TR1	G 1"	48,0	19,5	157,0	137,5	90,0

6820

Silencer with stainless steel AISI 304 wire mesh on nylon base

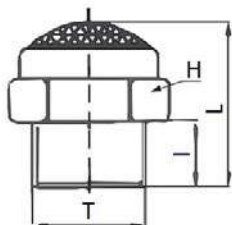

CODE	T	I	L	H	dB 4 Bar	dB 6 Bar	g
6820TR18	G 1/8"	6	15	13	70	74	1,5
6820TR14	G 1/4"	8	20	16	69	72	2,8
6820TR38	G 3/8"	8	20	19	85	88	4,5
6820TR12	G 1/2"	10	22	24	85	90	7,5

6850

Silencer with stainless steel AISI 304 wire mesh on an stainless steel AISI 304 hexagonal

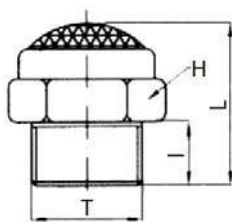

CODE	T	I	L	H	dB 4 Bar	dB 6 Bar	g
6850TR18	G 1/8"	6	15	13	70	74	5,0
6850TR14	G 1/4"	7	18	16	69	72	1,0
6850TR38	G 3/8"	8	20	19	85	88	1,5
6850TR12	G 1/2"	10	22	24	85	90	2,5
6850TR34	G 3/4"	10	26	30	86	90	4,0
6850TR1	G 1"	12	28	36	88	92	9,5

6880

Silencer with stainless steel AISI 316L mesh on stainless steel AISI 316L base - BSPP thread

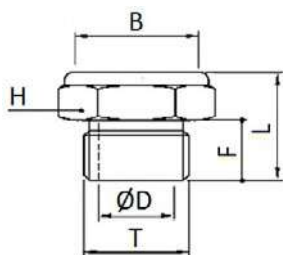

CODE	T	ØD	B	F	L	H	dB 4 Bar	dB 6 Bar	g
6880TR18	G 1/8"	6,0	10,0	8,0	15,0	14,0	-	-	8,0
6880TR14	G 1/4"	8,0	12,5	8,0	15,0	17,0	-	-	12,0
6880TR38	G 3/8"	12,0	17,5	10,0	18,0	22,0	-	-	20,0
6880TR12	G 1/2"	15,0	21,5	12,0	22,0	27,0	-	-	38,0
6880TR34	G 3/4"	20,0	28,0	15,0	27,0	32,0	-	-	62,0
6880TR1	G 1"	26,0	34,0	18,0	32,0	41,0	-	-	118,0



6882

Silencer with stainless steel AISI 316L mesh on stainless steel AISI 316L base - NPT thread

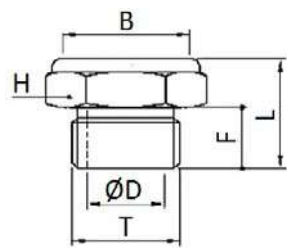

CODE	T	ØD	B	F	L	H	dB 4 Bar	dB 6 Bar	g
6882TR18	N 1/8"	6,0	9,0	7,0	14,0	14,0	-	-	8,0
6882TR14	N 1/4"	8,0	13,0	11,0	18,0	17,0	-	-	12,0
6882TR38	N 3/8"	12,0	18,0	11,0	18,0	22,0	-	-	20,0
6882TR12	N 1/2"	15,0	22,5	15,0	25,0	27,0	-	-	38,0
6882TR34	N 3/4"	20,0	28,0	16,0	27,0	32,0	-	-	62,0
6882TR1	N 1"	26,0	34,0	19,0	32,0	41,0	-	-	118,0

6885

Regulated silencer with stainless steel AISI 316 wire mesh on stainless steel AISI 316 hexagonal

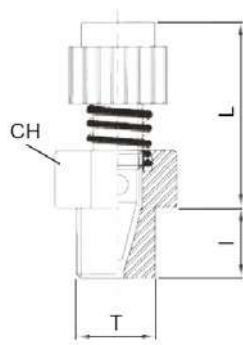

CODE	T	I	L min	L max	CH	dB 4 Bar	dB 6 Bar
6885TR18	G 1/8"	6	20,0	22,0	13	69	72
6885TR14	G 1/4"	8	22,0	24,0	15	70	73

