

Stainless Steel AISI 316-L

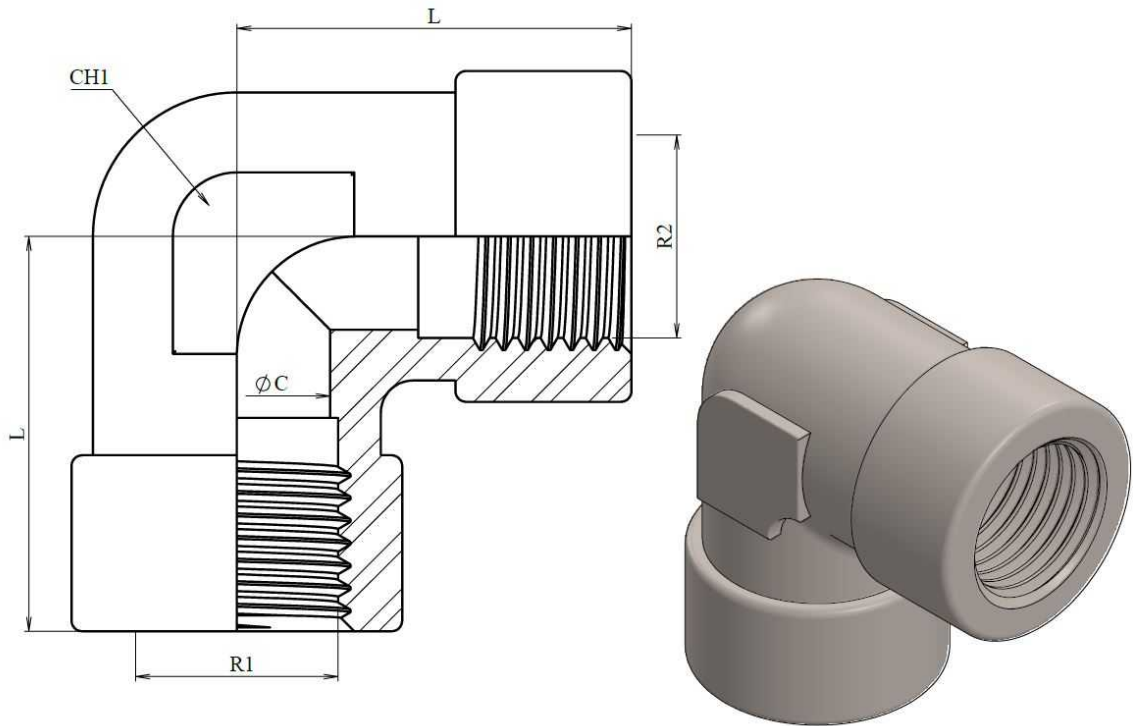

Part nº	R1	R2	L	CH1	ØC
<b>Z119602</b>	1/8" BSP	1/8" BSP	21,5	12	6
<b>Z119604</b>	1/4" BSP	1/4" BSP	28,5	20	8
<b>Z119606</b>	3/8" BSP	3/8" BSP	35	24	12
<b>Z119608</b>	1/2" BSP	1/2" BSP	37	28	17,5
<b>Z119612</b>	3/4" BSP	3/4" BSP	45	28	16
<b>Z119616</b>	1" BSP	1" BSP	50,75	36	25