

#### HOSE NIPPLE, DIN 74304

RACCORD QUEUE LISSE, DIN 74304  
 SCHLAUCHSTUTZEN, DIN 74304  
 BICO PARA FLEXÍVEL DE FREIO, DIN 74304

ARTICLE NO.	H	D	L	HEX	WEIGHT
6237994	11	M16x1,5	40	22	44
6237997	11	M22x1,5	40	28	69
6237995	13	M16x1,5	40	22	60
6237996	13	M22x1,5	40	28	70

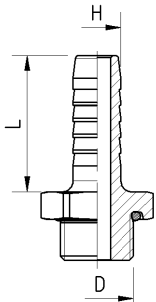

#### HOSE NIPPLE, RAUFOSS COUPLINGS® STANDARD

RACCORD QUEUE CANNELÉE, STANDARD RAUFOSS COUPLINGS®  
 SCHLAUCHSTUTZEN, NACH RAUFOSS COUPLINGS® NORM  
 BICO PARA FLEXÍVEL DE FREIO, PADRÃO RAUFOSS COUPLINGS®

ARTICLE NO.	H	D	L	HEX	WEIGHT
6237926	9,5	M16x1,5	30	22	43
6237927	9,5	M22x1,5	30	28	72
6237905	10	M16x1,5	30	22	46
6237912	10	M22x1,5	30	28	72
6237906	11	M12x1,5	30	22	47
6237907	11	M16x1,5	30	22	41
6237915	11	M22x1,5	30	28	68
6237908	13	M16x1,5	30	22	41
6237914	13	M22x1,5	30	28	67
6237911	14,5	M16x1,5	30	22	49
6237913	14,5	M22x1,5	30	28	79

IF THE PRODUCT YOU ARE LOOKING FOR IS NOT IN THIS CATALOGUE, PLEASE CONTACT US FOR INFORMATION ON ALTERNATIVE SOLUTIONS.

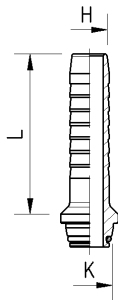

### HOSE NIPPLE, WITH 24° CONE

RACCORD QUEUE CANNELÉE, AVEC CÔNE 24°  
SCHLAUCHSTUTZEN, MIT 24°-KONUS UND O-RING  
BICO PARA FLEXÍVEL DE FREIO COM CONE 24°

ARTICLE NO.	H	K1	NUT	L	WEIGHT
6238992	9	K 24° - 10	616 1146	40	18
6238993	11	K 24° - 12	616 1147	40	21
6238983	3/8"	K 24° - 12	616 1147	40	22
6238994	1/2"	K 24° - 12	616 1149	40	27

**EN:** KINDLY PURCHASE THE NUT SEPARATELY.  
TO BE USED TOGETHER WITH A 24° CONE COUPLING.

**DE:** ÜBERWURFMUTTER GESONDERT BESTELLEN.  
ANSCHLUSS AN SCHOTTSTUTZEN ODER ADAPTER MIT KONUS(24°).

**FR:** ÉCROU VENDU SÉPARÉMENT.  
À UTILISER AVEC UN RACCORD AVEC CONE 24°.

**PO:** A PORCA É VENDIDA SEPARADMENTE.  
DEVE SER USADA EM CONJUNTO COM UMA CONEXÃO DE AR  
24° CÔNICA.

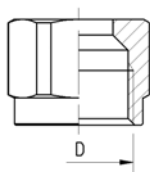

### NUT FOR HOSE NIPPLE

ÉCROU POUR RACCORD QUEUE CANNELÉE  
ÜBERWURFMUTTER, FÜR SCHLAUCHSTUTZEN  
PORCA PARA BICO DE FLEXÍVEL DE FREIO

ARTICLE NO.	D1	HOSE NIPPLE	HEX	WEIGHT
6161146	M16x1,5	623 8992	19	19
6161147	M18x1,5	623 8993	22	26
6161149	M18x1,5	623 8994	22	25

IF THE PRODUCT YOU ARE LOOKING FOR IS NOT IN THIS CATALOGUE, PLEASE CONTACT US FOR INFORMATION ON ALTERNATIVE SOLUTIONS.