



NBR: $-5^{\circ}\text{C} \div 70^{\circ}\text{C}$
EPDM: $-40^{\circ}\text{C} \div 140^{\circ}\text{C}$



From 0,5 to 10 Bar
Minimum open pressure:
 0.025 Bar
Maximum open pressure:
 0.07 Bar



Compressed air and fluids
 compatible with construction
 materials.



Parallel BSPP UNI ISO 228/1
 from G1/8" to G1/2"
 Metric ISO 262 M5



One way fluids flow.
 Indication of the fluid direction
 engraved on the body.



Body: brass nickel plated
Shutter with ball: AISI 304
Spring: AISI 302
O'ring: NBR 70

ADVANTAGES

Realized with sphere stopper which guarantees the advantage to eliminate the friction of the components and, at the same time, to increase the lifetime.



Products in compliance with
 the directive 2002/95/EC

RoHS2

Products in compliance with
 the directive 2011/65/EU

1700L

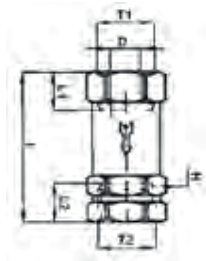

F/F check valve with ball BSPP & metric thread nickel brass PN 10

CODE	T1	T2	D	L1	L2	I	H	GR.
1700TRM5L	M5	M5	2,8	6,0	6,0	24	10	13
1700TR18L	G1/8"	G1/8"	5,0	8,0	8,0	31	13	28
1700TR14L	G1/4"	G1/4"	7,0	9,5	9,5	37	16	35
1700TR38L	G3/8"	G3/8"	8,5	10,5	10,5	42	20	59
1700TR12L	G1/2"	G1/2"	10,0	12,0	12,0	50	25	78

1701L

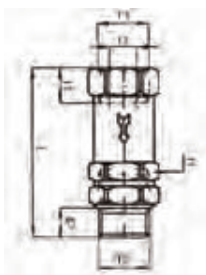

F/M check valve with ball BSPP thread brass nickel plated PN 10 - OUT

CODE	T1	T2	D	I1	I2	L	H	GR.
1701TR18L	G1/8"	G1/8"	5,0	8,0	8,0	39	13	31
1701TR14L	G1/4"	G1/4"	7,0	9,5	9,5	46	16	38

1701L-IN

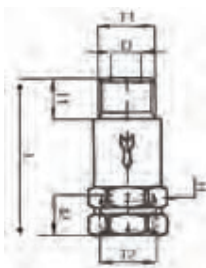

M/F check valve with ball BSPP thread brass nickel plated PN 10 - IN

CODE	T1	T2	D	I1	I2	L	H	GR.
1701TR18L-IN	G1/8"	G1/8"	5,0	7,0	8,0	30	13	30
1701TR14L-IN	G1/4"	G1/4"	7,0	8,0	9,5	35	16	36

