

# Accessories

## Connector TT rail Series



### Description

The asa rail system is the first worldwide flexible mounting and connection system for air blast heat exchangers. The flexibility comes from free choice of the port's direction. Each port on the radiator has 3 possibilities. This well designed radiator concept brings another flexibility innovation hit to the standard cooler market: The oil flow direction can be chosen between u-flow direction and diagonal oil flow on each TT rail cooler!

The radiator rail slots are not only for connecting the hydraulic ports, it is also possible to have the system attached with e.g.: bypass systems, mounting of the cooler to an aggregate, measurement devices, and much more. Please contact us to discover the huge potential of this rail system for your application.

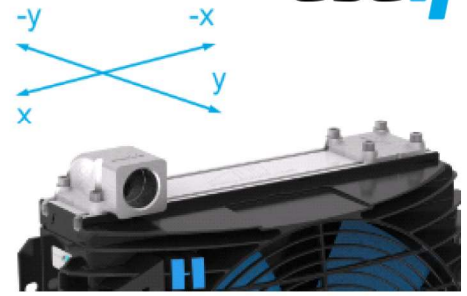

### Dimensions

#### ported 90° connector

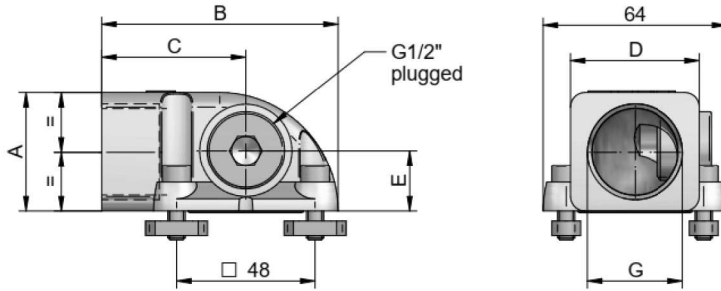

#### ported straight connector

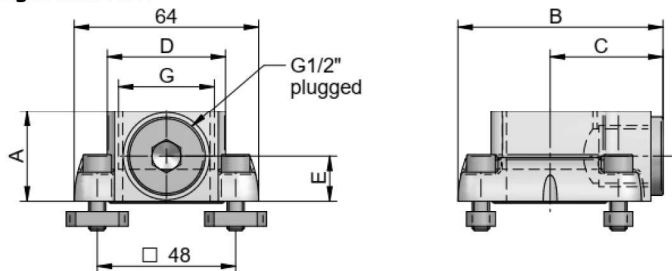

#### blind connector

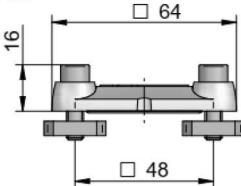

#### Possible oil flow directions with asa rail system!

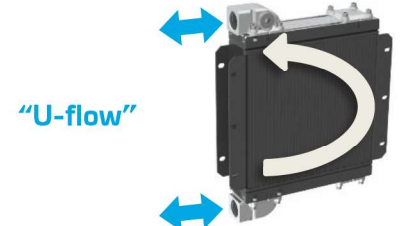

**In- and outlet not on same side!**



### Technical Data with NBR-sealing

order number	description	o-ring	A	B	C	D	E	G	connection type	weight
			[mm]	[mm]	[mm]	[mm]	[mm]			[kg]
ILLZSET5G25	asa rail connector 90° G 1"	NBR	41	82	50	45	21	G 1"	2x 90°	0,90
ILLZSET5G32	asa rail connector 90° G 1 1/4"		50	88	56	50	21	G 1 1/4"	2x 90°	1,05
ILLZSET5G25A	asa rail connector straight G 1"		31	67	35	41	15	G 1"	2x straight	0,66
ILLZSET5G25B	asa rail connector 90°+straight G 1"		See technical drawing					G 1"	1x 90°, 1x straight	0,77
ILLZSET5G32A	asa rail connector straight G 1 1/4"		33	75	43	55	15	G 1 1/4"	2x straight	0,74
ILLZSET5G32B	asa rail connector 90°+straight G 1 1/4"		See technical drawing					G 1 1/4"	1x 90°, 1x straight	0,89
ILLZSET5U12	asa rail connector 90° UNF 1 1/16-12		41	82	50	45	21	UNF 1 1/16	2x 90°	0,90
ILLZSET5U16	asa rail connector 90° UNF 1 5/16-12		41	82	50	45	21	UNF 1 5/16	2x 90°	0,90
ILLZSET5U20	asa rail connector 90° UNF 1 5/8-12		50	88	56	50	21	UNF 1 5/8	2x 90°	1,10
ILLZSET5U16A	asa rail connector straight UNF 1 5/16-12		31	71	39	41	15	UNF 1 5/16	2x straight	0,68
ILLZSET5U16B	asa rail connector 90°+straight UNF 1 5/16-12		See technical drawing					UNF 1 5/16	1x 90°, 1x straight	0,76
ILLZSET5U20A	asa rail connector straight UNF 1 5/8-12		33	75	43	55	15	UNF 1 5/8	2x straight	0,74

This data sheet and the corresponding scale drawings are to be used as a general guideline and technical overview of our products. Please contact us if more exact information is needed. As we are constantly improving our products, their characteristics, dimensions and weights may also change, although we do our best to incorporate these changes continually. asa assumes no liability for any information therein, any errors, omissions, misprints, nor any direct or indirect damages, losses or costs resulting therefrom. Any cooling performances and general technical values indicated in this catalogue are measured at a test bench according to asa testing procedures or calculated, based on such tests. They represent a basis for your product selection. Due to different conditions in testing and application environments the performance may also vary by +/- 15%. All sound values are determined in accordance with ISO 9614-2, DIN EN ISO 11203 accuracy class 3 or Machinery Directive 2006/42/EG and are A-rated. At some of the performance data, possible differences to competition data are possible. The reason to that are no existing standardized testing procedures on individual subjects, e.g. for cooling performance measurements. Therefore, we recommend all products to be checked under the system operating conditions. This is also true of vibrations and mechanical stress as well as for pressure peaks and thermal stress and any other relevant factors. General tolerances according to DIN ISO 2768-vL, General tolerances for casted parts according to EN ISO 8062-3 (DCTG 10). Tolerances for rubber parts are according to ISO 3302-1 (class M4-F4C). The tolerances of welding seams are defined by quality group D according to EN ISO 10042, if it is not specified on the actual scale drawing or data sheet. Any form of liability is excluded for the information included in this datasheet. All details and calculation values are checked to the best of our ability, but these do not ensure any intrinsic product properties: due to the wide-ranging possible applications, it is advised that all technical data herewith included be confirmed through testing carried out by the end-user. asa technology Produktions- und Vertriebs GmbH reserves the right to modify the product without any separate notification. This refers to both technical data and the product itself. Furthermore, it is herewith specified that the datasheet does not substitute the corresponding scale drawings, assembly and installation guidelines, nor the operating instructions. DK-Flex-exchanger-TT-Rail-en-rev0-Draft2 © asa technology, December 2023 18/28

### Technical Data with HNBR sealing

order number	description	o-ring	A	B	C	D	E	G	connection type	weight
			[mm]	[mm]	[mm]	[mm]	[mm]			[kg]
ILLZSET5G25H	asa rail connector 90° G 1" HNBR	HNBR	41	82	50	45	21	G 1"	2x 90°	0,90
ILLZSET5G32H	asa rail connector 90° G 1 ¼" HNBR		50	88	56	50	21	G 1 ¼"	2x 90°	1,05

### Content

ported connector with plugged G ½"	2x
blind connector	1x
o-ring	3x
slot nut	12x
screw M6x20	12x

requires 1 set per cooler



packed size: 1 set

### Duplex Rail

The new Duplex rail connector can be used to easily connect our TT rail coolers in series, extending the performance of the series, and adding new dimensional options within our current performance ranges. This versatile system also simplifies the documentation and logistics for both the OEM and end user (e.g. manuals, spare part lists,...). Contact us to discover the full potential and available options for this system, [support@asahydraulik.com](mailto:support@asahydraulik.com).

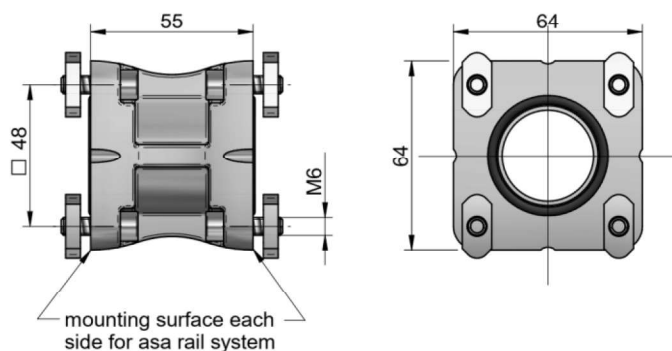

Typical connection application:  
requires  
2 x Standard Rail system coolers  
1 x ILLZSETSG25  
1 x ILLZSET5032K

### Technical Data

order number	description	connector material	o-ring	weight
				[kg]
ILLZSET5032K	connector TT rail duplex kit	aluminium	NBR, 35 x 3 mm	0,80

### Content

connector	2x
o-ring	4x
screw M6x20	16x
slot nut	16x

