

HYDRAULIC-TYPE GREASE NIPPLES - SPECIAL DESIGNS

The following types are representing only the most commonly used special-type nipples. For individual applications, manufactures hydraulic-type grease nipples with special equipment in other versions, with respect to the following:

- dimension
- material
- thread size
- thread form (e. g. with tapered thread)
- length



High-pressure hydraulic-type nipple with pin valve



- straight version A/180°
- made of steel, zinc-plated and passivated
- with special pin valve

Due to the special pin valve, the lubrication point will be sealed hermetically after the greasing operation. As a result, internal impulse-like pressures up to 400 bar (5,800 PSI) can be attained, depending on the respective application.

APPLICATION AREA

Heavy Industry, Heavy Vehicle Industry.

GW M 10 x 1.0				Ref.- No.:			
L1	L2	SW		Steel	Brass	SST303	SST316L
21	7.5	11mm HEX	●	5800049			
21	9	11mm HEX	●	5800052		5800050	

GW R 1/8, 1/8 - 28 BSP				Ref.- No.:			
L1	L2	SW		Steel	Brass	SST303	SST316L
21	7.5	11mm HEX	●	5800054		5800051	
21	9	11mm HEX	●	5800053			

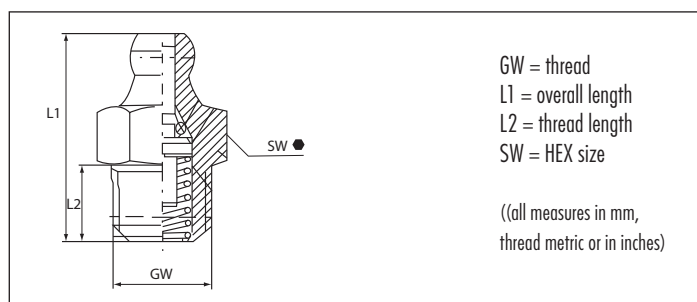

OPERATING INSTRUCTIONS

ATTENTION! During dismantling, utmost caution is required because of the possible pressure load. Dismantling should be done by experienced personnel only!

GW G 1/8, 1/8 - 28 BSPP				Ref.- No.:			
L1	L2	SW		Steel	Brass	SST303	SST316L
21	7	13mm HEX	●	5800056			

GW G 1/4, 1/4 - 19 BSPP				Ref.- No.:			
L1	L2	SW		Steel	Brass	SST303	SST316L
21	7	13mm HEX	●			5800057	

GW 1/8" - 27 NPT/PTF				Ref.- No.:			
L1	L2	SW		Steel	Brass	SST303	SST316L
21	7.5	11mm HEX	●	5800048			
21	9	11mm HEX	●			5800040	

Hydraulic-type nipple with sealing element



- angled version B/45°
- made of steel, zinc-plated and passivated
- head hardened according to DIN
- with cylindrical thread
- with sintered sealing element under the collar

APPLICATION AREA

Heavy Industry, Heavy Vehicle Industry.

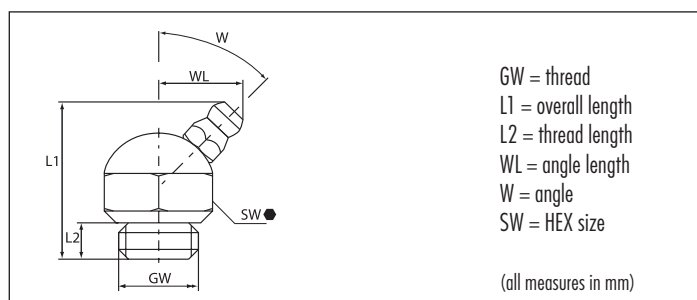

GW					M 14 x 2.0		Ref.- No.:			
L1	L2	WL	W	SW	Steel	Brass	SST303	SST316L		
26.6	7	14	45°	19 mm HEX	5242042					

Hydraulic-type nipple, double headed



- made of steel, zinc-plated and passivated
- heads hardened according to DIN
- optionally available as:
 - H2-double head with 67° angle / hexagon body
 - H3-double head with 90° angle / square body

APPLICATION AREA

Option of alternative greasing by means of two heads.

GW M 6 x 1.0						Ref.- No.:			
L1	L2	WL	W	SW		Steel	Brass	SST303	SST316L
18	5.5	14.5	90°	9mm SQ. ■		5244179			

GW M 8 x 1.0						Ref.- No.:			
L1	L2	WL	W	SW		Steel	Brass	SST303	SST316L
18	5.5	14.5	90°	9mm SQ. ■		5244178			
18	5.5	14.5	90°	11mm SQ. ■		5244181			
20	5.5	13.5	67°	11mm HEX ●		5244159			

GW M 8 x 1.25						Ref.- No.:			
L1	L2	WL	W	SW		Steel	Brass	SST303	SST316L
18	5.5	14.5	90°	9mm SQ. ■		5244096			
20	5.5	13.5	67°	11mm HEX ●		5244160			
24	5.5	14.5	90°	9mm SQ. ■		5244033			

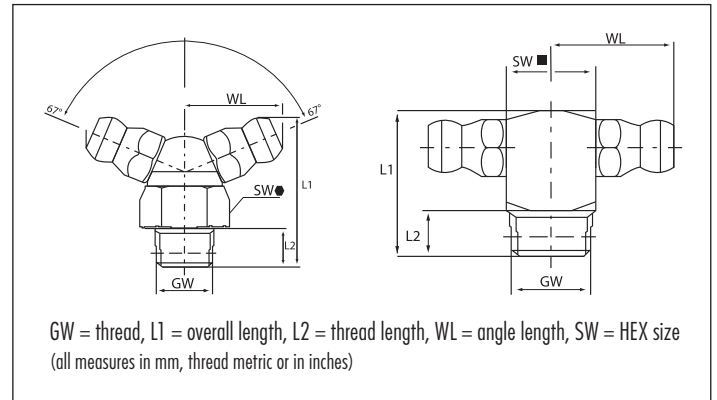

GW M 10 x 1.0						Ref.- No.:			
L1	L2	WL	W	SW		Steel	Brass	SST303	SST316L
18	5.5	15	90°	11mm SQ. ■		5244094		5244134	
20	5.5	13.5	67°	11mm HEX ●		5244161			
22	7	13.5	67°	11mm HEX ●		5244163			

GW R 1/8, 1/8 - 28 BSP						Ref.- No.:			
L1	L2	WL	W	SW		Steel	Brass	SST303	SST316L
18	5.5	15	90°	11mm SQ. ■		5244095			
20	5.5	13.5	67°	11mm HEX ●		5244162			

Hydraulic-type nipple with extension



- straight version A/180°
- made of steel, zinc-plated and passivated
- head hardened according to DIN
- with tapered thread
- with press-fitted extension for exact grease flow

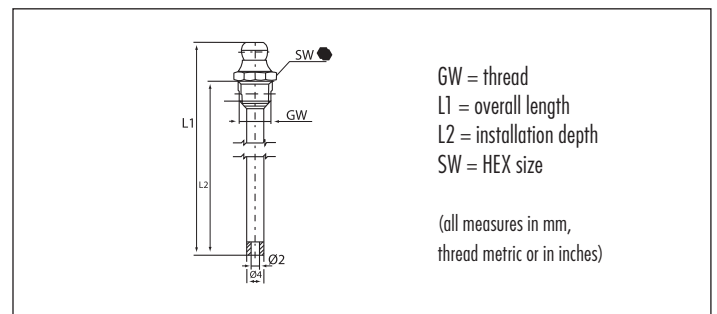

APPLICATION AREA

For deep seated lubrication points, which can be serviced sufficiently through the extension, e.g. for drive shafts.

GW M 8 x 1.0						Ref.- No.:			
L1	L2		SW			Steel	Brass	SST303	SST316L
75	65		9mm HEX ●			5241130			
130	120		9mm HEX ●			5241133			

GW M 8 x 1.25						Ref.- No.:			
L1	L2		SW			Steel	Brass	SST303	SST316L
32	22		9mm HEX ●			5241213			

GW M 10 x 1.0						Ref.- No.:			
L1	L2		SW			Steel	Brass	SST303	SST316L
59	49		11mm HEX ●			5241140			
75	65		11mm HEX ●			5241132			

GW 5/16" - 24 NF/UNF/SAE						Ref.- No.:			
L1	L2		SW			Steel	Brass	SST303	SST316L
75	65		9mm HEX ●			5241131			