

## Rubrik 8.24

### WV - Equal Elbows - Standard

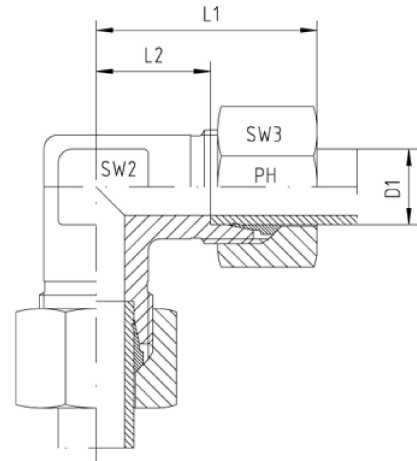

Pressure	Tube O.D.	Approx. Dimensions					Order-Code
PN	D1	L1	L2	SW2	SW3		
<b>Series LL</b>							
100	4	21	11,0	9	10	WV-LL-04	
100	6	21	9,5	9	12	WV-LL-06	
100	8	23	11,5	12	14	WV-LL-08	
<b>Series L</b>							
500	6	27	12,0	12	14	WV-L-06	
500	8	29	14,0	12	17	WV-L-08	
500	10	30	15,0	14	19	WV-L-10	
400	12	32	17,0	17	22	WV-L-12	
400	15	36	21,0	19	27	WV-L-15	
400	18	40	23,5	24	32	WV-L-18	
250	22	44	27,5	27	36	WV-L-22	
250	28	47	30,5	36	41	WV-L-28	
250	35	56	34,5	41	50	WV-L-35	
250	42	63	40,0	50	60	WV-L-42	
<b>Series S</b>							
800	6	31	16,0	12	17	WV-S-06	
800	8	32	17,0	14	19	WV-S-08	
800	10	34	17,5	17	22	WV-S-10	



630	12	38	21,5	17	24	WV-S-12
630	14	40	22,0	19	27	WV-S-14
630	16	43	24,5	24	30	WV-S-16
420	20	48	26,5	27	36	WV-S-20
420	25	54	30,0	36	46	WV-S-25
420	30	62	35,5	41	50	WV-S-30
420	38	72	41,0	50	60	WV-S-38