

Rubrik 8.270

BSP - Parallel - With Soft Sealing - Form A

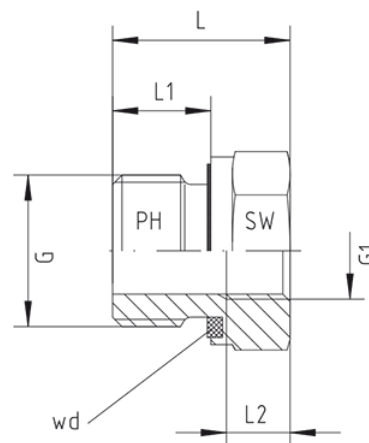
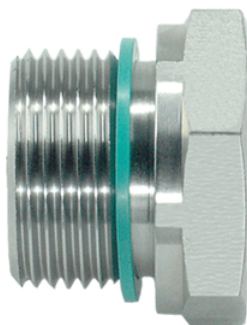

Form A

Both Threads: BSP - Parallel - DIN / ISO 228

wd = Sealing by an Elastomer Profiled Ring - FPM

Pressure	Male Thread	Female Thread	Approx. Dimensions				Form	Order-Code
PN	G	G1	L	L1	L2	SW		
630	G 3/8"	G 1/8"	22,5	12,0	8,0	22	A	GRI-3/8"-wd x 1/8"
630	G 1/2"	G 1/4"	24,0	14,0	12,0	27	A	GRI-1/2"-wd x 1/4"
630	G 1/2"	G 1/8"	24,0	14,0	8,0	27	A	GRI-1/2"-wd x 1/8"
400	G 3/4"	G 3/8"	26,0	16,0	13,0	32	A	GRI-3/4"-wd x 3/8"
400	G 3/4"	G 1/4"	26,0	16,0	12,0	32	A	GRI-3/4"-wd x 1/4"
400	G 3/4"	G 1/8"	26,0	16,0	8,0	32	A	GRI-3/4"-wd x 1/8"
400	G 1"	G 1/2"	29,0	18,0	14,0	41	A	GRI-1"-wd x 1/2"
400	G 1"	G 3/8"	29,0	18,0	12,0	41	A	GRI-1"-wd x 3/8"
400	G 1"	G 1/4"	29,0	18,0	12,0	41	A	GRI-1"-wd x 1/4"
400	G 1 1/4"	G 3/4"	32,0	20,0	16,0	50	A	GRI-1 1/4"-wd x 3/4"
400	G 1 1/4"	G 1/2"	32,0	20,0	14,0	60	A	GRI-1 1/4"-wd x 1/2"
400	G 1 1/4"	G 3/8"	32,0	20,0	17,0	50	A	GRI-1 1/4"-wd x 3/8"
315	G 1 1/2"	G 1"	36,0	22,0	18,0	55	A	GRI-1 1/2"-wd x 1"
315	G 1 1/2"	G 3/4"	36,0	22,0	16,0	55	A	GRI-1 1/2"-wd x 3/4"
315	G 1 1/2"	G 1/2"	36,0	22,0	14,0	55	A	GRI-1 1/2"-wd x 1/2"
250	G 2"	G 1 1/2"	42,0	22,5	18,5	70	A	GRI-2"-wd x 1 1/2"
250	G 2"	G 1 1/4"	42,0	22,5	18,5	70	A	GRI-2"-wd x 1 1/4"
250	G 2"	G 1"	42,0	22,5	18,5	70	A	GRI-2"-wd x 1"

250	G 2"	G 3/4"	42,0	22,5	16,0	70	A	GRI-2"-wd x 3/4"
250	G 2"	G 1/2"	41,5	22,5	16,0	70	A	GRI-2"-wd x 1/2"