

GREASE LUBRICATION PUMPS HAMAX SYSTEM 2



TECHNICAL DATA

HYDRAULIC MOTOR

Supply: Hydraulic hammer circuit, 870 – 4600 psi (60-320 bar)
Differential pressure in operation: min. 440 psi (30 bar)
Admissible return pressure: max. 430 psi (30 bar)
Volume flow drive medium: 0.21-0.74 gal/min. (0.8-2.8 l/min.)
Preset speed of the eccentric: 14 r.p.m. [with oil ISO VG 46 at 68°F (20°C) and a volume flow of the drive medium at 0.4 gal/min. (1.5 l/min.)]
Hydraulic oil: ISO VG 32-100
Temperature range: -4°F up to 158°F (-20°C up to +70°C)
 Speed can be adjusted by throttle

PUMP ELEMENTS

Pressure limiting valve: 4000 psi (280 bar)
Delivery rate/stroke PE120FH: 0.12 cm³
Default stroke number: 14 strokes/min.
 Stroke number can be adjusted by throttle

GENERAL

Lubricant: EP-grease without solid contents or chisel pastes up to NLGI class 2
Grease supply: different types of cartridges for version M14 and M16 - S, F, L, R, Ra, J, Fu; corresponding adapters are available (delivery without grease cartridge)
Weight: approx. 14.7 lbs (6.7 kg)
 Grease zerk for manual greasing available
 Four different lubricant outlets possible

KEY FEATURES

- Tool-mounted, hydraulically actuated grease pump
- Continuous, automatic lubrication protects against chisel wear
- Recommended for copper-based chisel pastes
- Adjustable output rates to suit equipment and application

*Notice:

Adjustment of the revolutions of the eccentric (pump delivery rate) is made via an adjusting throttle, the oil flow rate requiring adjustment on each pump individually. The values of the throttle rotations in the table above are to assist adjustment.

DELIVERY RATE DIAGRAM*

The following diagram shows the guide values for adjustment of the throttle. Before adjustment, screw the throttle clockwise inwards to its stop. By unscrewing the throttle counter-clockwise, you can adjust the required delivery rate. If the required delivery rate is not known, you can assume a range between 0.5 and 1.0 cm³/min. for most hydraulic hammers.

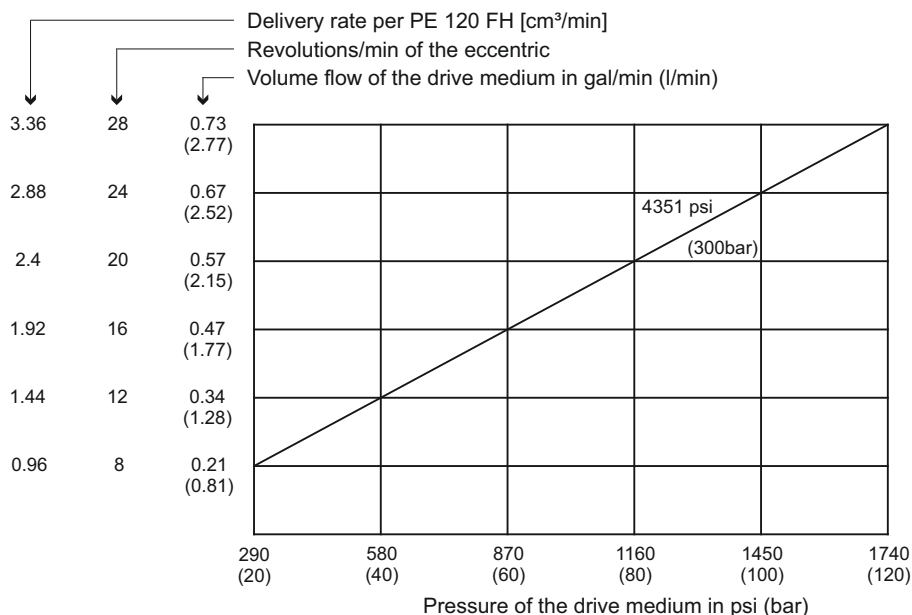

Values at lubricant counter pressure 290 psi (20 bar) and fully opened throttle.
 The delivery volume can be reduced by screwing in the throttle.

issue: 10.19EN

GREASE LUBRICATION PUMPS HAMAX SYSTEM 2

TECHNICAL DRAWINGS (delivery without grease cartridge)

Version M14

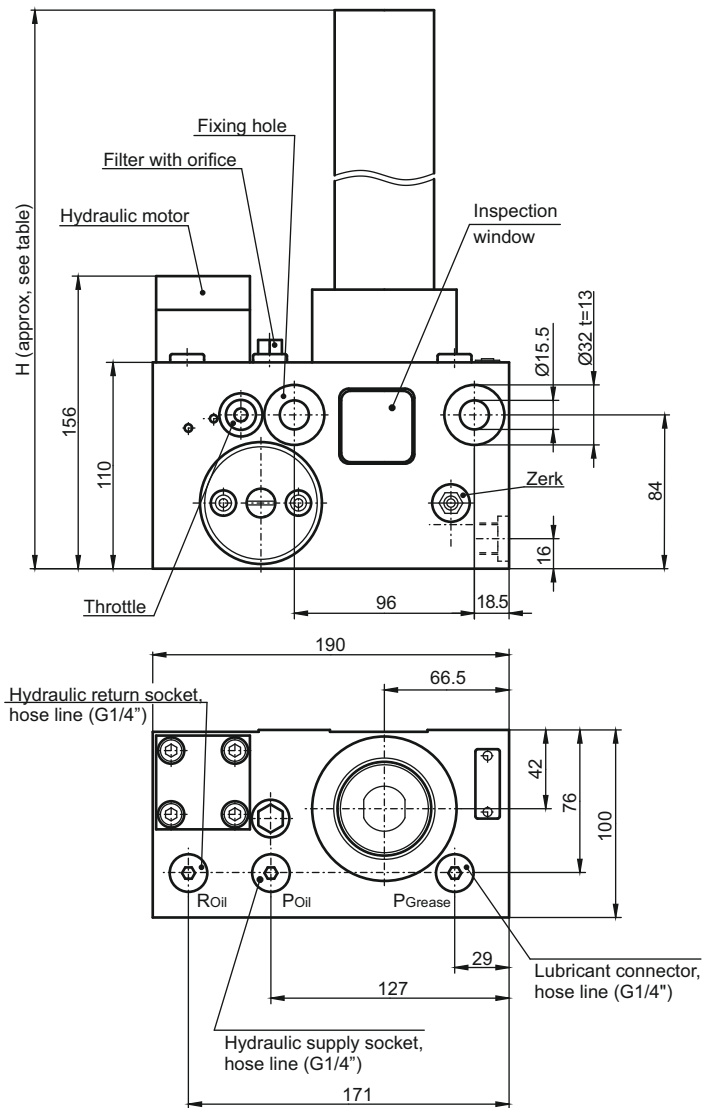

Version M16

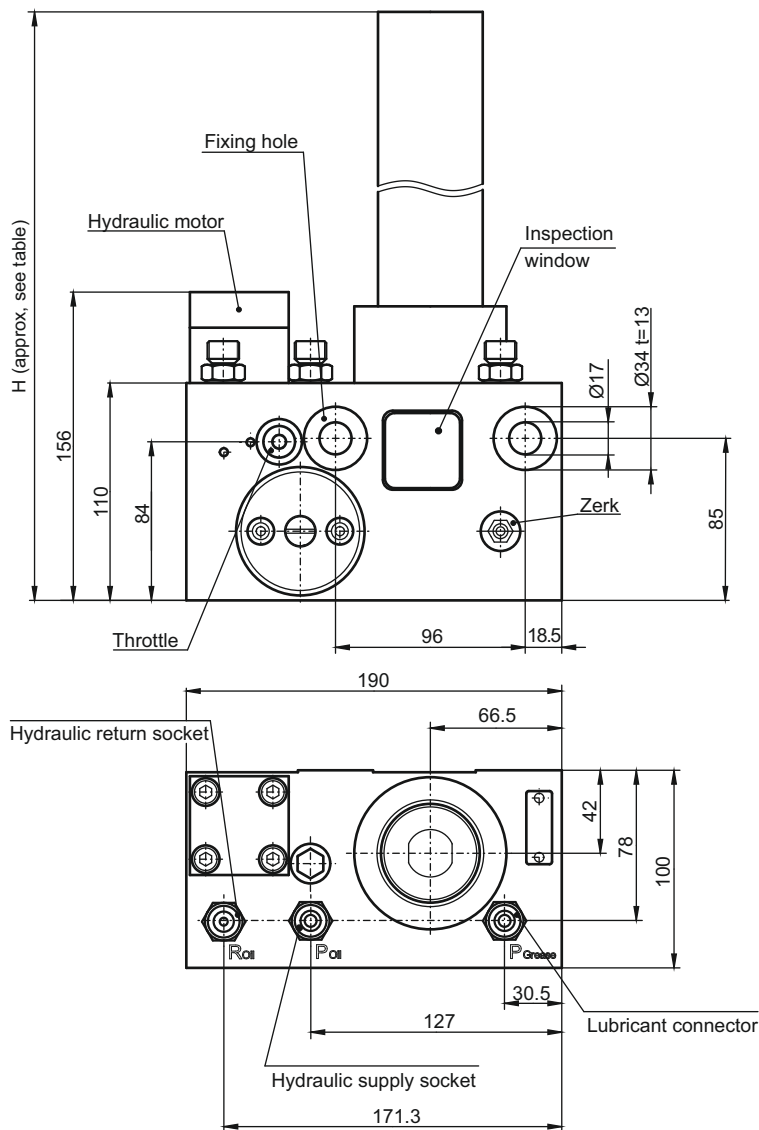

Base order code: 2576 ...Hamax System 2

Cartridge type	Vers. M14 + M16 (mm)
S	300
L	265
F	310
J	285
Fu	325
R	300
Ra	290

issue: 10.19EN