

## Pressure / Temperature Sensor ■ Type Sensor-PPC-04/12-PT

B

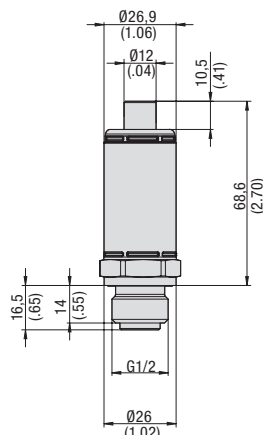

SDA-20-G1/2-W3

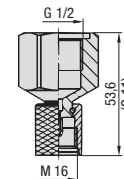

SAD-20/15-B-W3

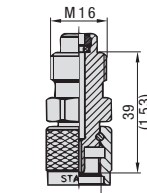
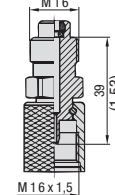

SAD-20/12-B-W3

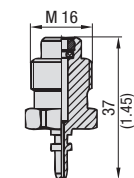

SAD-20/10-B-W3

### Product Description

The Pressure / Temperature Sensor-PPC-04/12-PT can be used with all Hydraulic Testers of the PPC series, due to the 5-pin connection. This sensor is able to measure and display temperatures on the Hydraulic Testers.

Due to their sturdy Stainless Steel design, the quick response time (< 1 ms) and the high accuracy ( $\pm 0.25\%$  FS\* typ.) with automatic sensor recognition, the Pressure / Temperature Sensor is a reliable and flexible solution for the Hydraulic Testers of the PPC series.

Note: A Connection Cable-PPC-04/12-3 (3 m / 9.84 ft) is needed to connect the Pressure / Temperature Sensor to the current Hydraulic Testers. An Extension Cable-PPC-04/12-5-EXT (5 m / 16.40 ft) is also available as an option. See page 46 for further information.

Sensor-PPC-04/12-PT-	
Pressure Measurement	yes
Temperature Measurement	yes
Process Connection	G1/2
Type	analogue 5-pin connection

### Technical Data

- Sturdy Stainless Steel housing (1.4301)
- FKM (Viton®) gasket
- Weight: 200 g / .44 lbs
- Suitable for gases and liquids (in the case of aggressive media, please contact STAUFF)
- 5-Pin connection
- Pressure connection G1/2 (without adaptor)

### Ambient Conditions

- Media temperature: -25 °C ... +105 °C / -13 °F ... +221 °F
- Ambient temperature: -25 °C ... +85 °C / -13 °F ... +185 °F
- Rel. humidity: < 80%
- Storage temperature: -25 °C ... +85 °C / -13 °F ... +185 °F
- Compensated range: 0 °C ... +85 °C / +32 °F ... +285 °F
- Load cycles (10<sup>6</sup>): 100

### Electrical Data

- Input voltage: 7 ... 12 V DC
- Output signal: 0 ... 3 V DC
- Response time: 1 ms
- Long-term stability: < 0.2 % FS\* / a
- Vibration loading: acc. to IEC 60068-2-6 (20g)
- Shock loading: acc. to IEC 60068-2-27 (50g)

### Protection Rating

- IP 54 protection rating: Dust protected and protected against splashing water

### Order Codes

**Sensor-PPC-04/12-PT - 015/2 - CAL**

①

②

③

#### ① Series and Type

Pressure / Temperature Sensor **Sensor-PPC-04/12-PT**

#### ② Version

See table

#### ③ Calibration

Without calibration certificate

(none)

With calibration certificate (factory calibration)

**CAL**

### Pressure Range and Accuracies

Version	Pressure Range and Accuracies							
Sensor-PPC-04/12-PT-	Pressure Measuring Range (bar/PSI)	Type of Measurement	Maximum Pressure (bar/PSI)	Burst Pressure (bar/PSI)	Accuracy (±% FS*) typ.	Accuracy (±% FS*) max.	Temperature Measuring Range (°C/°F)	Accuracy (±% FS*)
015/2	-1 ... 15	Relative pressure	30	150	0.25	0.5	-25 ... 105	1.5
	-14.5 ... 217		435	2175			-13 ... 221	
060/2	0 ... 60	Absolute pressure	120	500	0.25	0.5	-25 ... 105	1.5
	0 ... 870		1740	7251			-13 ... 221	
150/2	0 ... 150	Absolute pressure	300	900	0.25	0.5	-25 ... 105	1.5
	0 ... 2175		4351	13053			-13 ... 221	
400/2	0 ... 400	Absolute pressure	800	1200	0.25	0.5	-25 ... 105	1.5
	0 ... 5801		11603	17404			-13 ... 221	
600/2	0 ... 600	Absolute pressure	1200	1800	0.25	0.5	-25 ... 105	1.5
	0 ... 8702		17404	26106			-13 ... 221	
601/2	0 ... 600 **	Absolute pressure	1200	2500	0.25	0.5	-25 ... 105	1.5
	0 ... 8702		17404	36259			-13 ... 221	

\* FS = Full Scale

\*\* Pressure peaks up to 1000 bar / 14503 PSI

### Connection Adaptors for PPC Sensors

In addition to the Pressure / Temperature Sensors, different adaptors and adaptor sets are available that not only connect to the STAUFF Test 20 (SDA-20-G1/2-W3), but also to the Test

Couplings of the STAUFF Test 15/12/10 series

(SAD-20/15-B-W3, SAD-20/12-B-W3, SAD-20/10-B-W3).

For further information please see Catalogue 7 - STAUFF Test.