

**DIN 24° FDHORX90**

Female DIN 'O' ring swivel. 24° cone.

Heavy series. 90° swept elbow.

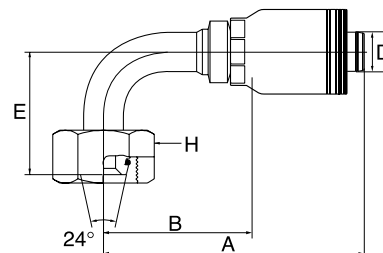

D				A	B	E	H	REF.
-size	DN	"		mm	mm	mm	mm	GSM
-24	40	1.1/2	M52 x 2.0	222.6	127.6	92.0	60.0	24GSM38FDHORX90

-24 size is 42.0 MPa (6000 psi).

**NPTF MP**

Male NPTF pipe.

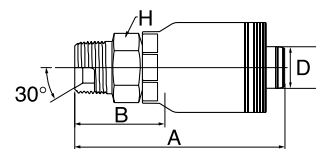

D				A	B	H	REF.
-size	DN	"		mm	mm	mm	GSM
-24	40	1.1/2	1.1/2" - 11.5 NPTF	165.3	70.3	50.8	24GSM24MP
-32	50	2	2" - 11.5 NPTF	191.6	77.6	69.9	32GSM32MP

-24 size is 24.5 MPa (3500 psi); -32 size is 17.5 MPa (2500 psi). / Warning: Use only in NPTF connections. Do not use in oil field (API) connections. Blow apart of an oil field connection can result in serious injuries.

**PLSOR**

Male Press-Lok Super 'O' ring.

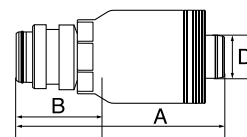

D			A	B	REF.
-size	DN	"	mm	mm	GSM
-24	40	1.1/2	181.1	86.1	24GSM24PLSOR
-32	50	2	204.8	90.8	32GSM32PLSOR

Unless otherwise stated the coupling meets the pressure rating requirements of the respective international standard.