

PIPE SCREW JOINTS

B MALE STUD ELBOWS



B MALE STUD ELBOW METRIC TAPER

Metric taper.

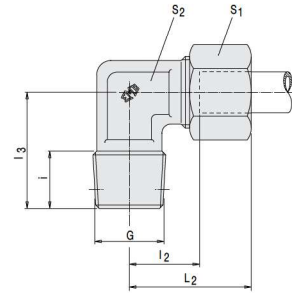

description	pipe OD	PN series	S ₁	S ₂	L ₂	l ₂	l ₃	i	G	kg / 100 pcs
B 4-MLL	4	LL 100 (400)	10	9	21	11.0	17	8	M 8x1 K	2.1
B 6-MLL	6		12	11	21	9.5	17	8	M 10x1 K	2.5
B 8-MLL	8		14	12	23	11.5	20	8	M 10x1 K	3.4
DS-B 6-ML	6	L 315 (1260)	14	12	27	12.0	20	8	M 10x1 K	4.0
DS-B 8-ML	8		17	14	29	14.0	26	12	M 12x1.5 K	6.6
DS-B 10-ML	10		19	17	30	15.0	27	12	M 14x1.5 K	8.3
DS-B 12-ML	12		22	19	32	17.0	28	12	M 16x1.5 K	11.8
DS-B 15-ML	15		27	19	36	21.0	32	12	M 18x1.5 K	12.0
DS-B 18-ML	18		32	24	40	23.5	36	14	M 22x1.5 K	19.1
DS-B 6-MS	6	S 630* (2520)	17	14	31	16.0	26	12	M 12x1.5 K	7.5
DS-B 8-MS	8		19	17	32	17.0	27	12	M 14x1.5 K	10.0
DS B 10 MS	10		22	19	34	17.5	28	12	M 16x1.5 K	13.8
DS-B 12-MS	12		24	22	38	21.5	28	12	M 18x1.5 K	16.5
DS-B 14-MS	14		27	19	40	22.0	32	14	M 20x1.5 K	15.3
DS-B 16-MS	16		30	24	43	24.5	32	14	M 22x1.5 K	19.0

L₂ = approximate length with nut tightened
OD 4 to 12 mm manufactured from profile material

* PN 630 applies only to taper port forms; PN 400 is applicable to parallel port forms

Please see "Engineering and technical data - Selecting the correct tube fitting" for more information on pressure.